



# 工具系统

## TOOLING SYSTEM

## 公司简介

About GESAC

厦门金鹭特种合金有限公司，成立于1989年，是一家中外合资的国家高新技术企业，隶属于中国六大稀土集团之一的厦门钨业股份有限公司。公司致力于高品质钨粉末材料、硬质合金、精密切削工具等钨系列产品的研发、生产，以及行业专业解决方案的提供，是世界知名的钨粉末、硬质合金及切削工具供应商。

凭借完整钨产业链的产品集成技术研发，以及务实、创新的管理理念，厦门金鹭始终保持着强劲的发展势头，为全球用户提供最高性价比的钨粉末产品和服务，为现代工业领域解决高硬度、耐高温、耐磨损问题，提供了优良的产品和完善的解决方案，客户遍布全球四十多个工业发达国家和地区，享誉海内外。

公司拥有3个生产基地，3个海外销售公司和1个企业技术中心，独立承担并完成多项“国家科技支撑计划项目”，“国家科技重大专项”，“国家火炬计划项目”，“国家重点新产品”开发项目及省市重点研究课题，被评为“战略性新兴产业骨干企业”、“创新型企业”、“先进技术企业”。

Xiamen Golden Egret Special Alloy Co., Ltd. (GESAC), founded in 1989, is a Sino-foreign joint venture with national high-tech, affiliated with XTC, which is one of six major rare earth groups in China. GESAC is committed to research & development, production and professional solutions providing of high-quality tungsten powder materials, cemented carbide, precision cutting tools and other tungsten products. Up to now, GESAC has become world-famous manufacturer and supplier of tungsten powder, cemented carbide and precision cutting tools products.

With the Integrated Product Development of complete tungsten industry chain, as well as a pragmatic and innovative management concept, GESAC has always maintained a strong momentum of development, providing the cost effective tungsten powder products and services for global users, offering the excellent products and perfect solutions for solving high hardness, high temperature resistance and wear resistance topics. Our brand "Golden Egret" has become one of the leading brand in the market, enjoying famous reputation in more than 40 countries and regions.

GESAC owns three production bases, three overseas sales branches and one R&D center. We undertook and completed several development programs independently, including the "National Science and Technology Support Programs", the "National Torch Program Projects", and the "National Key Projects" and so on. GESAC was awarded as "Key Enterprise for Strategic Emerging Industry", "Innovative Enterprise" and "Enterprise with Advanced Technology".



# 目录 Contents

A

BT 工具系统  
BT Tooling System

GHP 液压刀柄 GHP Hydraulic Chuck	08
SF热缩刀柄 SF Shrink Fit Holder	10
DSK/GSK高速精密筒夹刀柄 DSK/GSK High Precision Chuck	13
HPC高速精密强力铣刀柄 HPC High Speed Milling Chuck	17
ER弹性筒夹刀柄 ER Spring Collet Chuck	18
GLC强力筒夹刀柄 GLC Power Milling Chuck For Heavy Duty	20
GLN侧固式刀柄 GLN Side-lock Holder	21
MTA莫氏锥套刀柄 (钻头套筒) MTA Morse Taper Adapter	23
MTB莫氏锥套刀柄 (螺丝锁紧) MTB Morse Taper Holder	24
GPU整体式钻夹头刀柄 GPU Drill Chuck Holder	25
FMA/B平面铣刀柄 (直柄式) FMA/B Face Mill Holder	26
TPN扭力伸缩攻牙刀柄 TPN Tapping Chuck	29
VER同步微补偿攻牙刀柄 VER Tapping Chuck	30

B

HSK 工具系统  
HSK Tooling System

GHP 液压刀柄 GHP Hydraulic Chuck	32
SF热缩刀柄 SF Shrink Fit Holder	33
GSK高速精密筒夹刀柄 GSK High Precision Chuck	34
HPC高速精密强力铣刀柄 HPC High Speed Milling Chuck	35
ER弹性筒夹刀柄 ER Spring Collet Chuck	36
GLN侧固式刀柄 GLN Side-lock Holder	39
MTA莫氏锥套刀柄 (钻头套筒) MTA Morse Taper Adapter	42
GPU整体式钻夹头刀柄 GPU Drill Chuck Holder	42
FMB平面铣刀柄 FMB Face Mill Holder	43
VER同步微补偿攻牙刀柄 VER Tapping Chuck	44

C

配件  
Accessories

延长杆 Extenders	46
筒夹 Collets	50
螺帽 Nuts	60
扳手 Wrenches	63
拉钉 Pull Studs	66

D

附录  
Appendix

热缩刀柄使用注意事项 Announcements	70
刀柄尺寸图 Tool Holder Dimension	71

## 工具系统配置 Tooling System Arrangement Plan

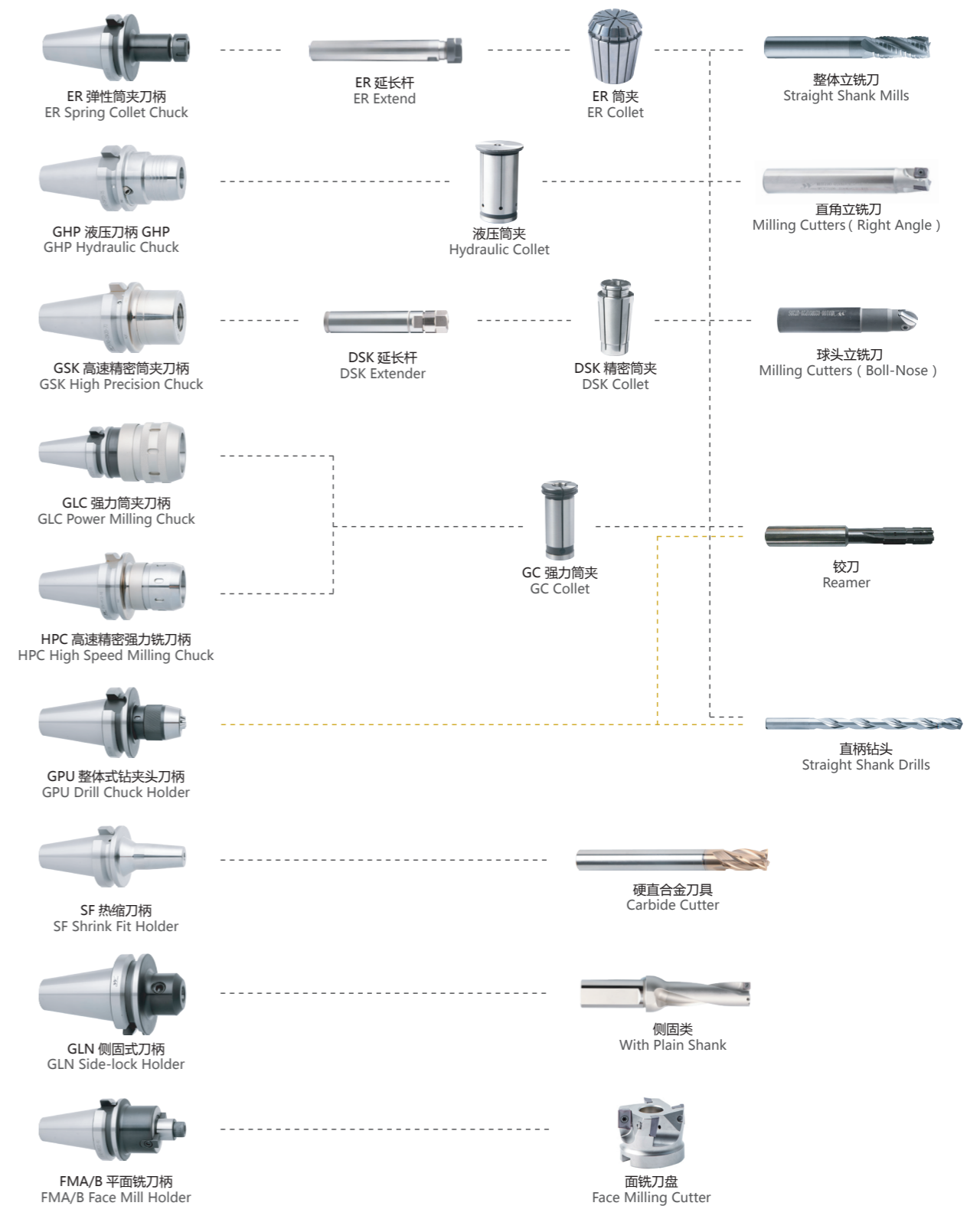

## GHP 液压刀柄

GHP Hydraulic Chuck

AT3 级别 7:24 锥度，经过深冷工艺处理，能有效防止变形，保持刀柄精度。  
7:24 ≤ AT3, cryogenic treatment reduces deformation to maintain the precision of the handle.

厚实与超细长刀体两种设计，应对不同加工环境，具有良好的减震及避让功能。  
The two designs of thick and thin blade are designed to cope with different processing environment, and have goods shock absorption and avoidance.

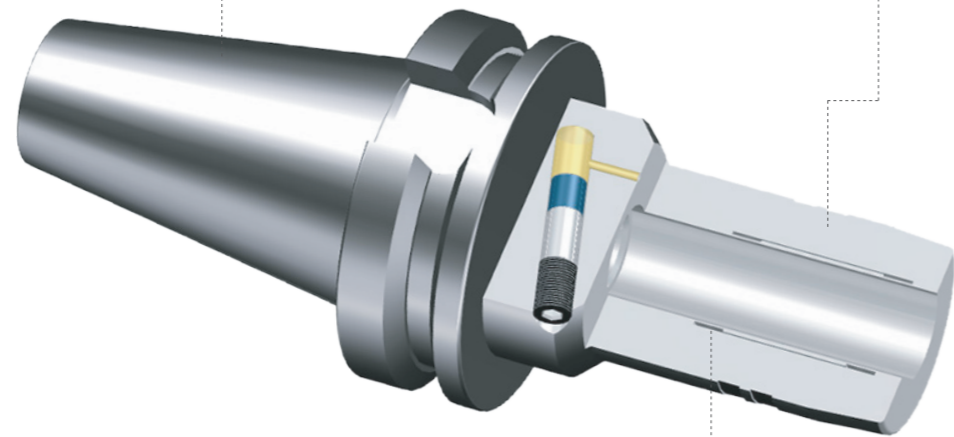

### 操作简单 / Simplicity of operator



操作简单，仅需一支T型扳手就可以完成刀具的装夹。  
Simple operation, only a T-wrench can complete the installation and disassembly of the tool.

刀体与内衬套一体化，比使用普通密封圈的分体结构更加稳定，刚性及耐用度更高。  
The integral of the chuck and the inner liner is more stable and rigid than the separation of the normal sealing ring.

### 3um 精度高 / Higher precision



3D 处刀具径向跳动 3um 以下，大幅度提高表面光洁度和刀具寿命。刀体动平衡：G2.5; 20000rpm, 最高转速：30000 rpm。  
Runout(X3D) ≤ 3um, increase surface-finish quality significantly and tool life, balanced: G2.5; 20000 rpm, Max: 30000 rpm.

### 出水方式 / Cooling

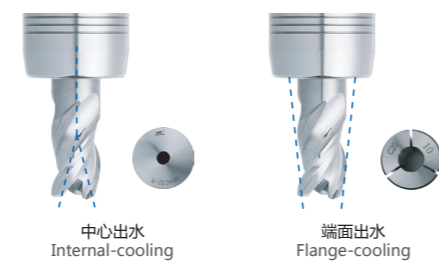

使用不同类型筒夹可以实现中心出水和端面出水的冷却方式。  
You can quickly switch internal-cooling and flange-cooling by change collets.

## GSK高速精密筒夹刀柄

GSK High Precision Chuck



无槽螺帽设计，提高整体平衡性，高转速下静音可靠，防止切削液飞溅。  
Notch-free design, prevent vibration, reduce noise splattering coolant, assure increased strength of nut itself.

广泛应用于模具、飞机汽车零部件等高速精密加工。  
It is widely used in mould, aircraft parts and other high speed precision processing industry.

AT3级别7:24锥度，经过深冷工艺处理，能有效防止变形，保持刀柄精度。  
7:24 ≤ AT3, cryogenic treatment reduces deformation to maintain the precision of the handle.

### 出水方式 / Cooling

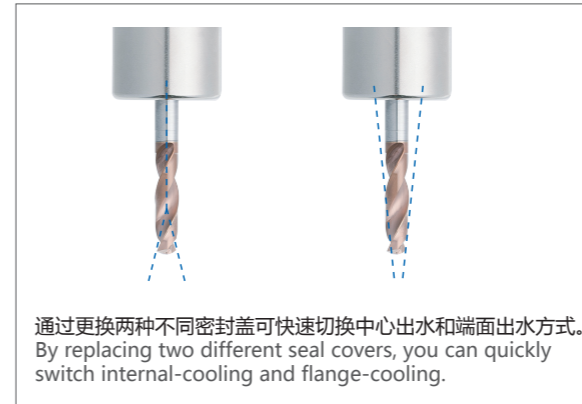

通过更换两种不同密封盖可快速切换中心出水和端面出水方式。  
By replacing two different seal covers, you can quickly switch internal-cooling and flange-cooling.

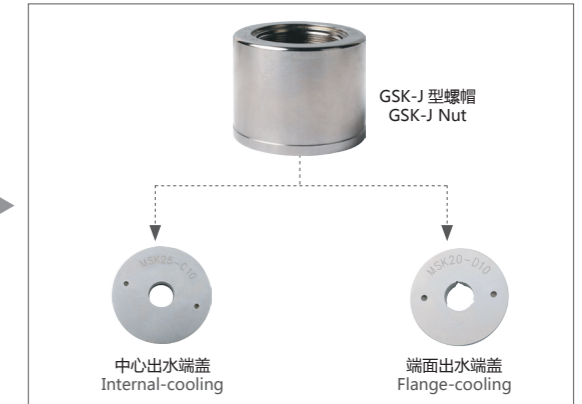

### 加持力大 / Higher clamping force

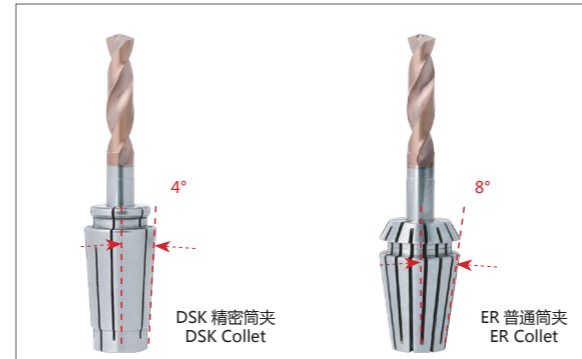

搭配新型 DSK 精密筒夹，夹持力更大，加工精度更高更稳定。  
With the new DSK collet, the clamping force is bigger and the precision is higher and more stable.

### 5um 精度高 / Higher precision

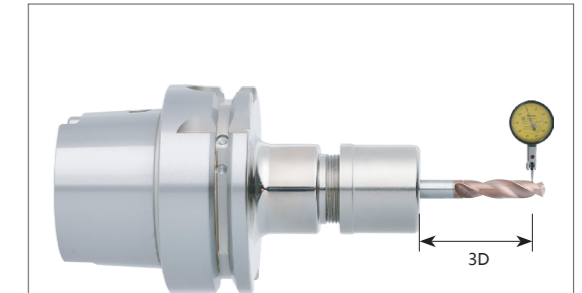

3D 处刀具径向跳动 5um 以下，大幅度提高表面光洁度和刀具寿命。刀体动平衡：G2.5; 25000 rpm, 最高转速：45000 rpm。  
Runout(X3D) ≤ 5um, increase surface-finish quality significantly and tool life, balanced: G2.5; 25000rpm, Max: 45000 rpm.

## GSK高速精密筒夹刀柄

GSK High Precision Chuck



3D 处刀具径向跳动 3um 以下，大幅度提高表面光洁度和刀具寿命。刀体动平衡：G2.5;25000 rpm，最高转速：50000 rpm。  
Runout(x3D) ≤ 3um, increase surface-finish quality significantly and tool life, balanced: G2.5;25000 rpm, Max: 50000 rpm.

广泛应用于模具、飞机汽车零部件等高速精密加工。  
It is widely used in mould, aircraft parts and other high speed precision processing industry.

AT3级别7:24锥度，经过深冷工艺处理，能有效防止变形，保持刀柄精度。  
7:24 ≤ AT3, cryogenic treatment reduces deformation to maintain the precision of the handle.

### 夹持力强 / Higher clamping force

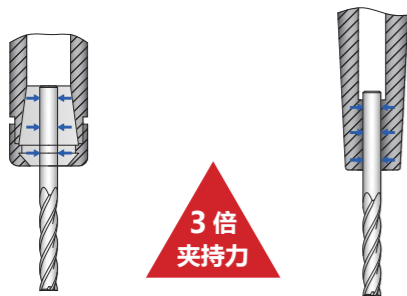

刀柄与刀具一体的结构使夹持力更均匀更强劲。  
The integrated structure of the handle and cutter brings a strong and uniform clamping force.

### 适合深腔加工 / Suitable for deep cavity processing

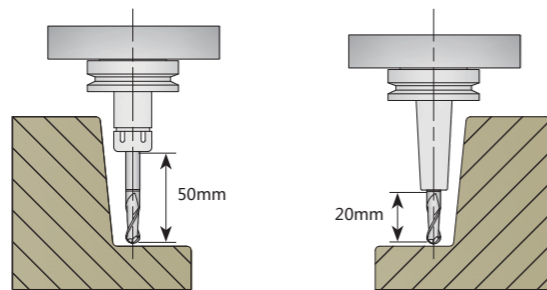

细长结构有利于避让，适用于深腔加工。  
The slender structure is good for avoiding and suitable for deep cavity processing.

### 适用刀具 / Applicable tools

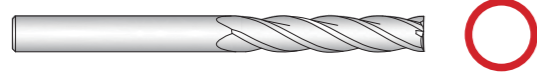

硬质合金刀具  
Cemented Carbide Tools

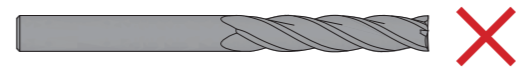

高速钢刀具  
High-speed Steel Tools



BT TOOLING SYSTEM

BT工具系统

A

### BT-GHP 液压刀柄

BT-GHP Hydraulic Chuck

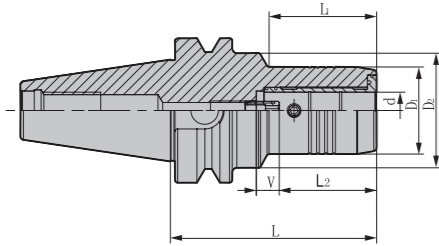

订货号 Ordering Code	尺寸 Dimension ( mm )								适用筒夹 Suit Collet	扳手 Wrench	重量 Weight ( kg )
	d	D1	D2	L	H	V	L1				
BT30-	GHP6-70	6	28	45	70	27.5	10	28	-	TH04T	0.68
	GHP8-70	8	30	45	70	27.5	10	28	-	TH04T	0.71
	GHP10-75	10	32	45	75	32.5	10	38	-	TH04T	0.73
	GHP12-75	12	34	45	75	37.5	10	36	D12/OD12	TH04T	0.78
	GHP14-85	14	36	45	85	37.5	10	44	-	TH04T	0.83
	GHP16-90	16	38	45	90	42.5	10	48	-	TH04T	0.92
	GHP18-90	18	41	45	90	42.5	10	48	-	TH04T	0.95
	GHP20-90	20	43	-	90	42.5	10	-	D20/OD20	TH04T	0.98
BT40-	GHP6-65	6	28	50	65	27.5	10	23	-	TH04T	1.26
	GHP6-90	6	28	50	90	27.5	10	44	-	TH04T	1.42
	GHP6-140	6	28	50	140	27.5	10	44	-	TH04T	2.16
	GHP8-65	8	30	50	65	27.5	10	23	-	TH04T	1.26
	GHP8-90	8	30	50	90	27.5	10	39	-	TH04T	1.43
	GHP8-140	8	30	50	140	27.5	10	44	-	TH04T	2.2
	GHP10-65	10	32	50	65	32.5	10	23	-	TH04T	1.26
	GHP10-90	10	32	50	90	32.5	10	44	-	TH04T	1.45
	GHP10-140	10	32	50	140	32.5	10	44	-	TH04T	2.4
	GHP12-65	12	34	50	65	37.5	10	23	D12/OD12	TH04T	1.26
	GHP12-90	12	34	50	90	37.5	10	44	D12/OD12	TH04T	1.46
	GHP12-140	12	34	50	140	37.5	10	44	D12/OD12	TH04T	2.6
	GHP14-65	14	36	50	65	37.5	10	23	-	TH04T	1.26
	GHP14-90	14	36	50	90	37.5	10	44	-	TH04T	1.48
	GHP14-140	14	36	50	140	37.5	10	44	-	TH04T	2.8
	GHP16-65	16	38	50	65	42.5	10	23	-	TH04T	1.27
	GHP16-90	16	38	50	90	42.5	10	48	-	TH04T	1.5
	GHP16-140	16	38	50	140	42.5	10	48	-	TH04T	2.8
	GHP18-75	18	41	50	75	42.5	10	30	-	TH04T	1.35
	GHP18-90	18	41	50	90	42.5	10	48	-	TH04T	1.53
GHP18-140	18	41	50	140	42.5	10	48	-	TH04T	2.85	
GHP19-75	19	43	50	75	101	10	30	-	TH04T	1.38	
GHP20-75	20	43	50	75	42.5	10	30	D20/OD20	TH04T	1.4	
GHP20-90	20	43	50	90	42.5	10	48	D20/OD20	TH04T	1.56	
GHP20-140	20	43	50	140	42.5	10	48	D20/OD20	TH04T	2.89	

### BT-GHP 液压刀柄

BT-GHP Hydraulic Chuck

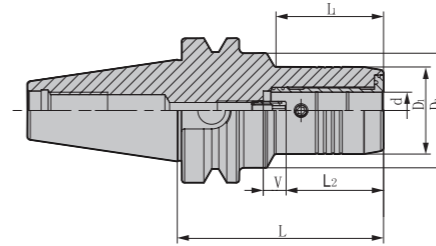

订货号 Ordering Code	尺寸 Dimension ( mm )								适用筒夹 Suit Collet	扳手 Wrench	重量 Weight ( kg )
	d	D1	D2	L	H	V	L1				
BT40-	GHP25-100	25	57	-	100	51	10	73	-	TH05T	2.05
	GHP25-135	25	57	-	135	51	10	108	-	TH05T	2.75
	GHP32-105	32	63	-	100	55	10	-	D32/OD32	TH05T	2.28
	GHP32-135	32	63	-	135	55	10	-	D32/OD32	TH05T	2.95
	GHP6-90	6	28	50	90	27.5	10	23	-	TH04T	4.03
	GHP6-120	6	28	50	120	27.5	10	44	-	TH04T	4.35
	GHP6-140	6	28	50	140	27.5	10	44	-	TH04T	4.65
	GHP8-90	8	30	50	90	27.5	10	23	-	TH04T	4.05
BT50-	GHP8-120	8	30	50	120	27.5	10	40	-	TH04T	4.42
	GHP8-140	8	30	50	140	27.5	10	44	-	TH04T	4.68
	GHP10-90	10	32	50	90	32.5	10	23	-	TH04T	4.06
	GHP10-120	10	32	50	120	32.5	10	44	-	TH04T	4.41
	GHP10-140	10	32	50	140	32.5	10	44	-	TH04T	4.71
	GHP12-90	12	34	50	90	37.5	10	23	D12/OD12	TH04T	4.07
	GHP12-120	12	34	50	120	37.5	10	44	D12/OD12	TH04T	4.43
	GHP12-140	12	34	50	140	37.5	10	44	D12/OD12	TH04T	4.73
	GHP14-90	14	36	50	90	37.5	10	23	-	TH04T	4.07
	GHP14-120	14	36	50	120	37.5	10	44	-	TH04T	4.43
	GHP14-140	14	36	50	140	37.5	10	44	-	TH04T	4.72
	GHP16-90	16	38	50	90	42.5	10	23	-	TH04T	4.08
	GHP16-120	16	38	50	120	42.5	10	48	-	TH04T	4.43
	GHP16-140	16	38	50	140	42.5	10	48	-	TH04T	4.73
	GHP18-90	18	41	50	90	42.5	10	32	-	TH04T	4.1
	GHP18-120	18	41	50	120	42.5	10	48	-	TH04T	4.47
	GHP18-140	18	41	50	140	42.5	10	48	-	TH04T	4.75
	GHP20-90	20	43	50	90	42.5	10	32	D20/OD20	TH04T	4.11
	GHP20-120	20	43	50	120	42.5	10	48	D20/OD20	TH04T	4.5
	GHP20-140	20	43	50	140	42.5	10	48	D20/OD20	TH04T	4.79
GHP25-105	25	57	-	105	51	10	67	-	TH05T	4.6	
GHP25-150	25	57	-	150	51	10	112	-	TH05T	5.4	
GHP32-115	32	63	-	115	55	10	77	D32/OD32	TH05T	4.85	
GHP32-150	32	63	-	150	55	10	112	D32/OD32	TH05T	5.67	

注：报价时含扳手，筒夹需单独订购。  
Notice: Wrench is included, while collet shall be ordered separately.

### BT-SF热缩刀柄

BT-SF Shrink Fit Holder

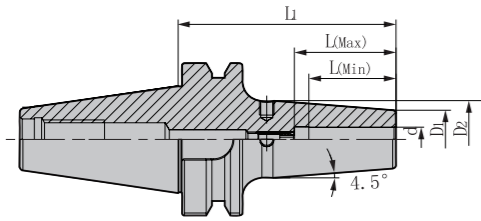

订货号 Ordering Code	尺寸 Dimension ( mm )						重量 Weight ( kg )	
	d	D1	D2	L1	L(Max)	L(Min)		
BT30-	SF3-80	3	10	10	80	-	9	0.35
	SF4-80	4	10	10	80	-	12	0.40
	SF5-80	5	10	10	80	-	15	0.43
	SF6-80	6	21	27	80	28	18	0.45
	SF8-80	8	21	27	80	34	24	0.50
	SF10-80	10	24	32	80	40	30	0.55
	SF12-80	12	24	32	80	40	30	0.62
	SF14-80	14	27	34	80	42	32	0.65
	SF16-80	16	27	34	80	42	32	0.68
	SF18-80	18	33	42	80	50	40	0.71
SF20-90	20	33	42	90	50	40	0.75	
BT40-	SF3-90	3	10	10	90	-	9	1.00
	SF4-90	4	10	10	90	-	12	1.10
	SF5-90	5	10	10	90	-	15	1.00
	SF6-90	6	21	27	90	28	18	1.15
	SF6-130	6	21	27	130	28	18	1.20
	SF6-160	6	21	27	160	28	18	1.40
	SF6-200	6	21	27	200	28	18	1.90
	SF8-90	8	21	27	90	34	24	1.15
	SF8-130	8	21	27	130	34	24	1.30
	SF8-160	8	21	27	160	34	24	1.50
	SF8-200	8	21	27	200	34	24	1.90
	SF10-90	10	24	32	90	40	30	1.20
	SF10-130	10	24	32	130	40	30	1.50
	SF10-160	10	24	32	160	40	30	1.80
	SF10-200	10	24	32	200	40	30	1.90
	SF12-90	12	24	32	90	40	30	1.30
	SF12-130	12	24	32	130	40	30	1.60
	SF12-160	12	24	32	160	40	30	1.80
	SF12-200	12	24	32	200	40	30	2.00
	SF14-90	14	27	34	90	42	32	1.30
SF14-130	14	27	34	130	42	32	1.60	

### BT-SF热缩刀柄

BT-SF Shrink Fit Holder

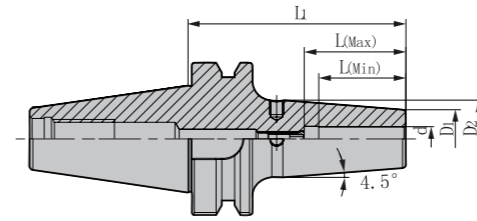

订货号 Ordering Code	尺寸 Dimension ( mm )						重量 Weight ( kg )	
	d	D1	D2	L1	L(Max)	L(Min)		
BT40-	SF14-160	14	27	34	160	42	32	1.80
	SF14-200	14	27	34	200	42	32	2.00
	SF16-90	16	27	34	90	42	32	1.40
	SF16-130	16	27	34	130	42	32	1.70
	SF16-160	16	27	34	160	42	32	1.95
	SF16-200	16	27	34	200	42	32	2.20
	SF18-90	18	33	42	90	50	40	1.50
	SF18-130	18	33	42	130	50	40	1.80
	SF18-160	18	33	42	160	50	40	2.00
	SF18-200	18	33	42	200	50	40	2.30
BT50-	SF20-90	20	33	42	90	50	40	1.55
	SF20-130	20	33	42	130	50	40	1.85
	SF20-160	20	33	42	160	50	40	2.05
	SF20-200	20	33	42	200	50	40	2.35
	SF25-100	25	44	53	100	55	45	1.65
	SF25-130	25	44	53	130	55	45	1.90
	SF25-160	25	44	53	160	55	45	2.20
	SF25-200	25	44	53	200	55	45	2.50
	SF32-100	32	44	53	100	60	50	2.00
	SF32-130	32	44	53	130	60	50	2.30
BT50-	SF6-100	6	21	27	100	28	18	3.70
	SF6-130	6	21	27	130	28	18	3.80
	SF6-160	6	21	27	160	28	18	3.88
	SF6-200	6	21	27	200	28	18	4.00
	SF8-100	8	21	27	100	34	24	3.60
	SF8-130	8	21	27	130	34	24	3.70
	SF8-160	8	21	27	160	34	24	3.90
	SF8-200	8	21	27	200	34	24	4.00
	SF10-100	10	24	32	100	40	30	3.65
	SF10-130	10	24	32	130	40	30	3.78
SF10-160	10	24	32	160	40	30	4.00	

### BT-SF热缩刀柄

BT-SF Shrink Fit Holder

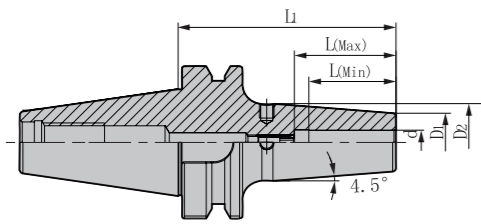

订货号 Ordering Code	尺寸 Dimension ( mm )						重量 Weight ( kg )
	d	D1	D2	L1	L(Max)	L(Min)	
SF10-200	10	24	32	200	40	30	4.15
SF12-100	12	24	32	100	40	30	3.70
SF12-130	12	24	32	130	40	30	3.80
SF12-160	12	24	32	160	40	30	4.10
SF12-200	12	24	32	200	40	30	4.25
SF14-100	14	27	34	100	42	32	3.70
SF14-130	14	27	34	130	42	32	3.80
SF14-160	14	27	34	160	42	32	4.10
SF14-200	14	27	34	200	42	32	4.25
SF16-100	16	27	34	100	42	32	3.75
SF16-130	16	27	34	130	42	32	3.88
SF16-160	16	27	34	160	42	32	4.20
SF16-200	16	27	34	200	42	32	4.50
SF18-100	18	33	42	100	50	40	3.75
BT50-SF18-130	18	33	42	130	50	40	3.88
SF18-160	18	33	42	160	50	40	4.20
SF18-200	18	33	42	200	50	40	4.50
SF20-100	20	33	42	100	50	40	3.80
SF20-130	20	33	42	130	50	40	4.00
SF20-160	20	33	42	160	50	40	4.30
SF20-200	20	33	42	200	50	40	4.60
SF25-100	25	44	53	100	55	45	3.82
SF25-130	25	44	53	130	55	45	4.05
SF25-160	25	44	53	160	55	45	4.33
SF25-200	25	44	53	200	55	45	4.65
SF32-100	32	44	53	100	60	50	4.00
SF32-130	32	44	53	130	60	50	4.40
SF32-160	32	44	53	160	60	50	4.70
SF32-200	32	44	53	200	60	50	5.00

特点 / Feature  
 • 动平衡设定 : G2.5; 25,000 rpm.  
 Balanced: G2.5; 25,000 rpm.  
 • 3D处径向跳动0.003mm以下。  
 Runout(X3D) ≤0.003mm.

### BT-DSK高速精密筒夹刀柄

BT-DSK High Precision Chuck

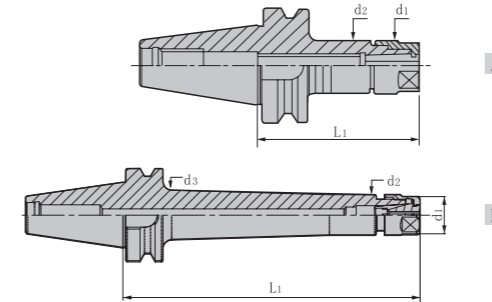

订货号 Ordering Code	图示 Figure	尺寸 Dimension ( mm )				适用筒夹 Suit Collet	重量 Weight ( kg )
		d1	d2	d3	L1		
DSK6-70	A	20	20	-	70	DSK6	0.45
DSK6-100	A	20	20	-	100	DSK6	0.64
DSK10-70	A	27.5	27.5	-	70	DSK10	0.46
DSK10-100	A	27.5	27.5	-	100	DSK10	0.70
DSK16-70	A	40.5	40.5	-	70	DSK16	0.70
BT30-DSK16-100	A	40.5	40.5	-	100	DSK16	1.00
DSK16-120	A	40.5	40.5	-	120	DSK16	1.25
DSK16-150	A	40.5	40.5	-	150	DSK16	1.35
DSK20-70	A	48.5	48.5	-	70	DSK20	0.75
DSK20-100	A	48.5	48.5	-	100	DSK20	1.15
DSK25-100	A	55	55	-	100	DSK25	1.20
DSK6-70	A	20	20	-	70	DSK6	1.05
DSK6-100	A	20	20	-	100	DSK6	1.25
DSK6-120	A	20	20	-	120	DSK6	1.39
DSK6-150L	B	20	20	26.4	150	DSK6	1.55
DSK10-70	A	27.5	27.5	-	70	DSK10	1.10
DSK10-100	A	27.5	27.5	-	100	DSK10	1.30
DSK10-120	A	27.5	27.5	-	120	DSK10	1.42
DSK10-150	A	27.5	27.5	-	150	DSK10	1.55
BT40-DSK10-200L	B	27.5	27.5	33.7	200	DSK10	1.85
DSK16-70	A	40.5	40.5	-	70	DSK16	1.21
DSK16-100	A	40.5	40.5	-	100	DSK16	1.42
DSK16-120	A	40.5	40.5	-	120	DSK16	1.61
DSK16-150	A	40.5	40.5	-	150	DSK16	1.80
DSK16-200L	B	40.5	40.5	45.7	200	DSK16	1.95
DSK20-70	A	48.5	48.5	-	70	DSK20	1.52
DSK20-100	A	48.5	48.5	-	100	DSK20	1.68
DSK20-120	A	48.5	48.5	-	120	DSK20	1.90
DSK20-150	A	48.5	48.5	-	150	DSK20	2.10



### BT-DSK高速精密筒夹刀柄

BT-DSK High Precision Chuck

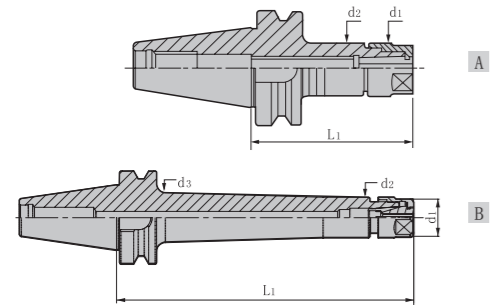

订货号 Ordering Code	图示 Figure	尺寸 Dimension ( mm )				适用筒夹 Suit Collet	重量 Weight ( kg )	
		d1	d2	d3	L1			
BT40-	DSK20-200L	B	48.5	48.5	55.7	265.4	DSK20	2.30
	DSK25-100	A	55	55	-	165.4	DSK25	1.81
	DSK25-120	A	55	55	-	185.4	DSK25	2.05
	DSK25-150	A	55	55	-	215.4	DSK25	2.30
	DSK25-200L	B	55	55	59.9	265.4	DSK25	2.65
BT50-	DSK10-105	A	27.5	27.5	-	206.8	DSK10	3.78
	DSK10-135	A	27.5	27.5	-	236.8	DSK10	4.00
	DSK10-165	A	27.5	27.5	-	266.8	DSK10	4.33
	DSK10-200L	B	27.5	27.5	35.2	301.8	DSK10	4.75
	DSK16-100	A	40.5	40.5	-	201.8	DSK16	3.93
	DSK16-125	A	40.5	40.5	-	226.8	DSK16	4.17
	DSK16-150	A	40.5	40.5	-	251.8	DSK16	4.49
	DSK16-200L	B	40.5	40.5	48.4	301.8	DSK16	5.50
	DSK16-250L	B	40.5	40.5	48.4	351.8	DSK16	6.50
	DSK20-100	A	48.5	48.5	-	201.8	DSK20	4.10
BT50-	DSK20-125	A	48.5	48.5	-	226.8	DSK20	4.32
	DSK20-150	A	48.5	48.5	-	251.8	DSK20	4.65
	DSK20-200	A	48.5	48.5	-	301.8	DSK20	5.75
	DSK20-250L	B	48.5	48.5	55.4	351.8	DSK20	6.78
	DSK20-300L	B	48.5	48.5	55.4	401.8	DSK20	7.80
	DSK25-100	A	55	55	-	201.8	DSK25	4.10
	DSK25-125	A	55	55	-	226.8	DSK25	4.62
	DSK25-150	A	55	55	-	251.8	DSK25	5.10
	DSK25-200	A	55	55	-	301.8	DSK25	5.81
	DSK25-250L	B	55	55	61.4	351.8	DSK25	6.85
DSK25-300L	B	55	55	61.4	401.8	DSK25	8.00	

注：筒夹与扳手需单独另购。  
Notice: Collets and wrenchs shall be ordered separately.

特点 / Feature  
 • 动平衡设定：G2.5；20,000 rpm。  
 Balanced: G2.5; 20,000 rpm.  
 • 3D处径向跳动0.005mm以下。  
 Runout(X3D) ≤ 0.005mm.

### BT-GSK高速精密筒夹刀柄

BT-GSK High Precision Chuck

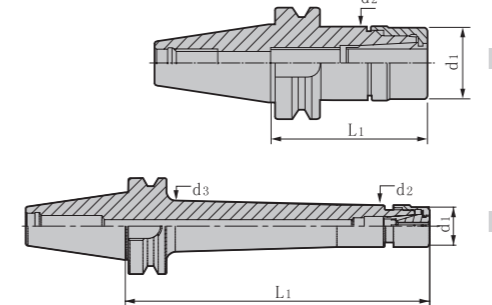

订货号 Ordering Code	图示 Figure	尺寸 Dimension ( mm )				适用筒夹 Suit Collet	重量 Weight ( kg )		
		d1	d2	d3	L1				
BT30-	GSK6-70	A	19.5	20	-	70	DSK6	0.45	
	GSK6-100	A	19.5	20	-	100	DSK6	0.64	
	GSK10-70	A	27	27.5	-	70	DSK10	0.46	
	GSK10-100	A	27	27.5	-	100	DSK10	0.70	
	GSK16-70	A	40	40.5	-	70	DSK16	0.70	
	GSK16-100	A	40	40.5	-	100	DSK16	1.00	
	GSK16-120	A	40	40.5	-	120	DSK16	1.25	
	GSK16-150	A	40	40.5	-	150	DSK16	1.35	
	GSK20-70	A	48	48.5	-	70	DSK20	0.75	
	GSK20-100	A	48	48.5	-	100	DSK20	1.15	
	GSK25-100	A	55	55	-	100	DSK25	1.20	
	BT40-	GSK6-70	A	19.5	20	-	70	DSK6	1.05
		GSK6-100	A	19.5	20	-	100	DSK6	1.25
		GSK6-120	A	19.5	20	-	120	DSK6	1.39
		GSK6-150L	B	19.5	20	26.4	150	DSK6	1.55
GSK10-70		A	27	27.5	-	70	DSK10	1.10	
GSK10-100		A	27	27.5	-	100	DSK10	1.30	
GSK10-120		A	27	27.5	-	120	DSK10	1.42	
GSK10-150		A	27	27.5	-	150	DSK10	1.55	
GSK10-200L		B	27	27.5	33.7	200	DSK10	1.85	
GSK16-70		A	40	40.5	-	70	DSK16	1.21	
GSK16-100		A	40	40.5	-	100	DSK16	1.42	
GSK16-120		A	40	40.5	-	120	DSK16	1.61	
GSK16-150		A	40	40.5	-	150	DSK16	1.80	
GSK16-200L		B	40	40.5	45.7	200	DSK16	1.95	
BT40-		GSK20-70	A	48	48.5	-	70	DSK20	1.52
	GSK20-100	A	48	48.5	-	100	DSK20	1.68	
	GSK20-120	A	48	48.5	-	120	DSK20	1.90	
	GSK20-150	A	48	48.5	-	150	DSK20	2.10	
	GSK20-200L	B	48	48.5	55.7	200	DSK20	2.30	
	GSK25-100	A	55	55	-	100	DSK25	1.81	

### BT-GSK高速精密筒夹刀柄

BT-GSK High Precision Chuck

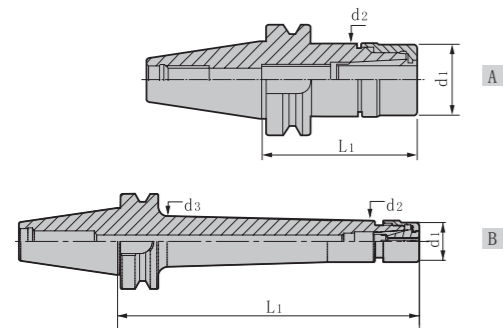

订货号 Ordering Code	图示 Figure	尺寸 Dimension ( mm )				适用筒夹 Suit Collet	重量 Weight ( kg )	
		d1	d2	d3	L1			
BT40-	GSK25-120	A	55	55	-	120	DSK25	2.05
	GSK25-150	A	55	55	-	150	DSK25	2.30
	GSK25-200L	B	55	55	59.9	200	DSK25	2.65
	GSK10-105	A	27	27.5	-	105	DSK10	3.78
	GSK10-135	A	27	27.5	-	135	DSK10	4.00
	GSK10-165	A	27	27.5	-	165	DSK10	4.33
	GSK10-200L	B	27	27.5	35.2	200	DSK10	4.75
	GSK16-100	A	40	40.5	-	100	DSK16	3.93
	GSK16-125	A	40	40.5	-	125	DSK16	4.17
	GSK16-150	A	40	40.5	-	150	DSK16	4.49
	GSK16-200L	B	40	40.5	48.4	200	DSK16	5.50
	GSK16-250L	B	40	40.5	48.4	250	DSK16	6.50
	BT50-	GSK20-100	A	48	48.5	-	100	DSK20
GSK20-125		A	48	48.5	-	125	DSK20	4.32
GSK20-150		A	48	48.5	-	150	DSK20	4.65
GSK20-200		A	48	48.5	-	200	DSK20	5.75
GSK20-250L		B	48	48.5	55.4	250	DSK20	6.78
GSK20-300L		B	48	48.5	55.4	300	DSK20	7.80
GSK25-100		A	55	55	-	100	DSK25	4.10
GSK25-125		A	55	55	-	125	DSK25	4.62
GSK25-150		A	55	55	-	150	DSK25	5.10
GSK25-200		A	55	55	-	200	DSK25	5.81
GSK25-250L	B	55	55	61.4	250	DSK25	6.85	
GSK25-300L	B	55	55	61.4	300	DSK25	8.00	

注：筒夹与扳手需单独另购，可选配中心出水螺帽与端面出水螺帽  
Notice: Collets and wrench shall be orderer separately, internal-cooling nuts and flange-cooling nuts see appendix for details.

特点 / Feature  
 • 动平衡设定: G2.5; 25,000 rpm.  
 Balanced: G2.5; 25,000 rpm.  
 • 3D处径向跳动0.005mm以下。  
 Runout(X3D) ≤0.005mm.

### BT-HPC高速精密强力铣刀柄

BT-HPC High-speed Milling Chuck

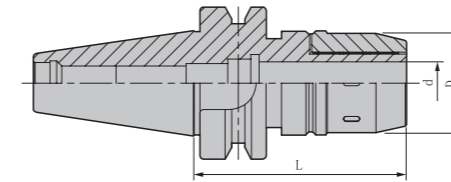

订货号 Ordering Code	范围 Range ( mm )	尺寸 Dimension ( mm )			适用筒夹 Suit Collet	重量 Weight ( kg )		
		D	d	L				
BT40-	HPC16-80	3-16	46	16	80	GC16	1.60	
	HPC16-105	3-16	46	16	105	GC16	1.80	
	HPC16-135	3-16	46	16	135	GC16	2.30	
	HPC20-80	6-20	51.5	20	80	GC20	2.40	
	HPC20-105	6-20	51.5	20	105	GC20	2.50	
	HPC20-135	6-20	51.5	20	135	GC20	2.80	
	HPC32-105	6-32	70.5	32	105	GC32	2.80	
	HPC32-135	6-32	70.5	32	135	GC32	3.00	
	BT50-	HPC16-90	3-16	46	16	90	GC16	3.90
		HPC16-110	3-16	46	16	110	GC16	4.10
HPC16-135		3-16	46	16	135	GC16	4.30	
HPC16-150		3-16	46	16	150	GC16	4.50	
HPC20-105		6-20	51.5	20	105	GC20	4.50	
HPC20-135		6-20	51.5	20	135	GC20	4.70	
HPC20-150		6-20	51.5	20	150	GC20	4.90	
HPC32-110		6-32	70.5	32	110	GC32	5.20	
HPC32-135		6-32	70.5	32	135	GC32	5.90	
HPC32-165		6-32	70.5	32	165	GC32	6.60	

注：报价时含扳手，筒夹需单独订购。  
Notice: Wrench is included, while collet is to be ordered separately.

特点 / Feature  
 • 动平衡设定: G6.3; 15,000 rpm.  
 Balanced: G6.3; 15,000 rpm.  
 • 3D处径向跳动0.02mm以下。  
 Runout(X3D) ≤0.02mm.

### BT-ER弹性筒夹刀柄

BT-ER Spring Collet Chuck

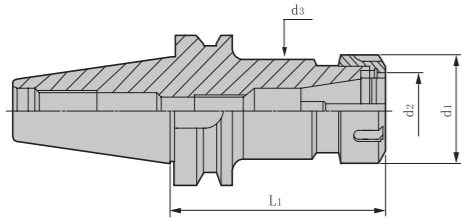

订货号 Ordering Code	尺寸 Dimension ( mm )				重量 Weight ( kg )	
	d1	d2	d3	L1		
BT30-	ER16-70	28	16	28	70	0.52
	ER16-100	28	16	28	100	0.64
	ER16-120	28	16	28	120	0.73
	ER20-70	34	20	34	70	0.57
	ER20-100	34	20	34	100	0.76
	ER20-135	34	20	34	135	0.99
	ER25-70	42	25	42	70	0.66
	ER32-70	42	25	42	100	0.98
	ER25-100	42	25	42	135	1.31
	ER25-135	50	32	50	70	0.72
	ER32-100	50	32	50	100	1.14
	ER40-80	63	40	63	80	1.20
BT40-	ER16-70	28	16	28	70	1.08
	ER16-100	28	16	28	100	1.21
	ER16-125	28	16	28	125	1.30
	ER16-150	28	16	28	150	1.44
	ER20-70	34	20	34	70	1.12
	ER20-100	34	20	34	100	1.33
	ER20-125	34	20	34	125	1.48
	ER20-150	34	20	34	150	1.65
	ER25-70	42	25	42	70	1.22
	ER25-100	42	25	42	100	1.49
	ER25-125	42	25	42	125	1.71
	ER25-150	42	25	42	150	1.97
	ER32-70	50	32	50	70	1.27
	ER32-100	50	32	50	100	1.70
	ER32-150	50	32	50	150	2.39
	ER32-200	50	32	50	200	3.12
	ER40-80	63	40	63	80	1.62
	ER40-100	63	40	63	100	2.08
ER40-120	63	40	63	120	2.55	
ER40-150	63	40	63	150	3.23	

### BT-ER弹性筒夹刀柄

BT-ER Spring Collet Chuck

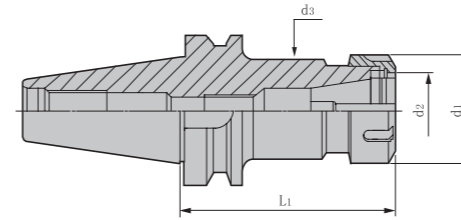

订货号 Ordering Code	尺寸 Dimension ( mm )				重量 Weight ( kg )	
	d1	d2	d3	L1		
BT50-	ER16-70	28	16	28	70	3.67
	ER16-100	28	16	28	100	3.77
	ER16-135	28	16	28	135	3.95
	ER16-165	28	16	28	165	4.04
	ER20-70	34	20	34	70	3.66
	ER20-100	34	20	34	100	3.75
	ER20-135	34	20	34	135	4.08
	ER20-150	34	20	34	150	4.22
	ER20-200	34	20	34	200	4.66
	ER20-250	34	20	34	250	5.16
	ER25-70	42	25	42	70	3.64
	ER25-100	42	25	42	100	4.02
	ER25-125	42	25	42	125	4.26
	ER25-150	42	25	42	150	4.54
	ER25-200	42	25	42	200	5.01
	ER25-250	42	25	42	250	5.52
	ER32-80	50	32	50	80	3.80
	ER32-100	50	32	50	100	4.07
	ER32-120	50	32	50	120	4.35
	ER32-150	50	32	50	150	4.82
	ER32-200	50	32	50	200	5.32
ER32-250	50	32	50	250	5.92	
ER40-80	63	40	63	80	3.93	
ER40-100	63	40	63	100	4.38	
ER40-120	63	40	63	120	4.86	
ER40-150	63	40	63	150	5.51	

注：报价时含扳手，筒夹需单独订购。  
Notice: Wrench is included, while collet is to be ordered separately.

### BT-GLC强力筒夹刀柄

BT-GLC Power Milling Chuck For Heavy Duty

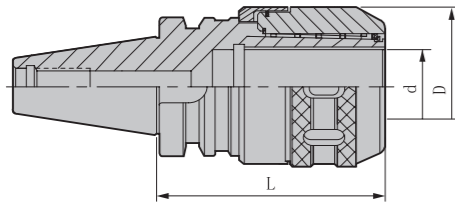

订货号 Ordering Code	范围 Range (mm)	尺寸 Dimension (mm)			适用筒夹 Suit Collet	重量 Weight (kg)	
		D	d	L			
BT30-	GLC20-75	6-20	51.5	20	75	GC20	1.59
	GLC20-100	6-20	51.5	20	100	GC20	1.73
BT40-	GLC20-80	6-20	51.5	20	80	GC20	1.85
	GLC20-100	6-20	51.5	20	100	GC20	2.11
	GLC20-135	6-20	51.5	20	135	GC32	2.65
BT50-	GLC32-105	6-32	70.5	32	105	GC32	2.28
	GLC32-135	6-32	70.5	32	135	GC32	2.87
	GLC20-105	6-20	51.5	20	105	GC20	4.30
BT50-	GLC20-150	6-20	51.5	20	150	GC20	5.83
	GLC32-110	6-32	70.5	32	110	GC32	4.52
	GLC32-135	6-32	70.5	32	135	GC32	5.44
	GLC32-165	6-32	70.5	32	165	GC32	6.19
	GLC32-200	6-32	70.5	32	200	GC32	6.95
	GLC42-115	6-42	86	42	115	GC42	5.50
	GLC42-135	6-42	86	42	135	GC42	6.43
	GLC42-165	6-42	86	42	165	GC42	7.65

注：报价时含扳手，筒夹需单独订购。  
Notice: Wrench is included, while collet shall be ordered separately.

特点 / Feature

- 刀柄采用四组 220 根针状滚针特殊排列而成。  
The tool holder uses four special layers with 220 pieces bearing arranged in particular.
- 端面锁紧增强了本体刚性强度。  
It can reduce the locking resistance and also show best performance on heavy cutting.
- 立铣刀无振动无滑移实现了最大能力范围的重铣削加工，跳动精度 0.02mm。  
The usual length of power milling chuck show that the highest runout accuracy can reach to 0.02mm.

### BT-GLN侧固式刀柄

BT-GLN Side-lock Holder

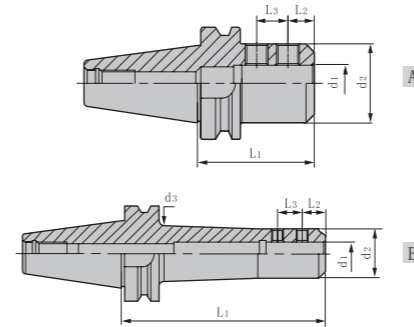

订货号 Ordering Code	图示 Figure	尺寸 Dimension (mm)						侧固螺钉 Screw	重量 Weight (kg)	
		d1	d2	d3	L1	L2	L3			
BT30-	GLN6-60	A	6	25	-	60	18	-	STBM060100	0.55
	GLN8-60	A	8	28	-	60	18	-	STBM080100	0.60
	GLN10-60	A	10	35	-	60	20	-	STBM100120	0.70
	GLN12-60	A	12	42	-	60	22.5	-	STBM120140	0.75
	GLN16-75	A	16	48	-	75	24	-	STBM140160	1.05
	GLN20-75	A	20	52	-	75	25	-	STBM160160	1.10
	GLN25-90	A	25	65	-	90	24	25	STCM180200	1.70
BT40-	GLN6-50	A	6	25	-	50	18	-	STBM060100	1.10
	GLN6-100	A	6	25	-	100	12	10	STBM060100	1.40
	GLN8-50	A	8	28	-	50	18	-	STBM080100	1.10
	GLN8-100	A	8	28	-	100	14	12	STBM080100	1.42
	GLN10-63	A	10	35	-	63	20	-	STBM100120	1.25
	GLN10-100	A	10	35	-	100	15	14	STBM100120	1.45
	GLN12-63	A	12	42	-	63	22.5	-	STBM120140	1.26
	GLN12-100	A	12	42	-	100	20	16	STBM120140	1.50
	GLN16-63	A	16	48	-	63	24	-	STBM140160	1.31
	GLN16-100	A	16	48	-	100	22	18	STBM140160	1.52
	GLN20-63	A	20	52	-	63	25	-	STBM160160	1.33
	GLN20-100	A	20	52	-	100	25	20	STBM160160	1.60
	GLN25-100	A	25	65	-	100	24	25	STCM180200	2.32
BT50-	GLN32-100	A	32	72	-	100	24	28	STCM200180	3.80
	GLN6-63	A	6	25	-	63	18	-	STCM200180	3.80
	GLN6-100	A	6	25	-	100	12	10	STCM060U080	4.20
	GLN8-63	A	8	28	-	63	18	-	STBM060080	3.80
	GLN8-100	A	8	28	-	100	14	12	STBM080100	4.22
BT50-	GLN10-63	A	10	35	-	63	18	-	STBM080100	3.80
	GLN10-100	A	10	35	-	100	15	14	STBM100120	4.25

### BT-GLN侧固式刀柄

BT-GLN Side-lock Holder

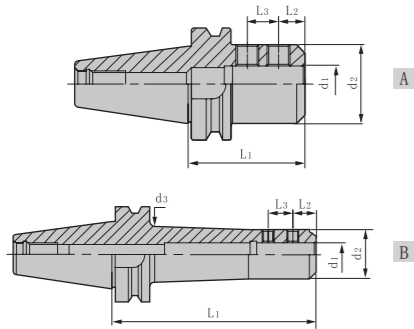

订货号 Ordering Code	图示 Figure	尺寸 Dimension (mm)							侧固螺钉 Screw	重量 Weight (kg)
		d1	d2	d3	L1	L2	L3			
GLN12-80	A	12	42	-	80	22.5	-	STBM120140	3.99	
GLN12-125	A	12	42	-	125	20	16	STBM120140	5.00	
GLN16-80	A	16	48	-	80	24	-	STBM140160	4.03	
GLN16-125	A	16	48	-	125	22	18	STBM140160	5.20	
GLN16-165L	B	16	48	53	165	22	18	STBM140160	6.30	
GLN20-80	A	20	52	-	80	25	-	STBM160160	4.03	
GLN20-125	A	20	52	-	125	25	20	STBM160160	5.30	
GLN20-165L	B	20	52	57	165	25	20	STBM160160	6.35	
GLN20-210L	B	20	52	59	210	25	20	STBM160160	7.25	
GLN25-100	A	25	65	-	100	24	25	STCM180200	4.62	
GLN25-165L	B	25	65	70	165	24	25	STCM180200	6.63	
GLN25-210L	B	25	65	70	210	24	25	STCM180200	7.30	
GLN32-105	A	32	72	-	105	24	28	STCM200180	4.80	
GLN32-165L	B	32	72	77	165	24	28	STCM200180	6.70	
GLN32-210L	B	32	72	77	210	24	28	STCM200180	7.50	
GLN40-115	A	40	90	-	115	30	32	STCM200250	5.42	
GLN42-120	A	42	90	-	120	30	32	STCM200250	6.14	
GLN42-210L	B	42	90	95	210	30	32	STCM200250	7.23	
GLN50-120	A	50	90	-	120	35	35	STCM200180	5.65	
GLN50.8-120	A	50.8	90	-	120	33	34.54	STCM200180	5.58	

注：扳手需单独订购。  
Notice: Wrenchs shall be ordered separately.

### BT-MTA莫氏锥套刀柄 (钻头套筒)

BT-MTA Morse Taper Holder

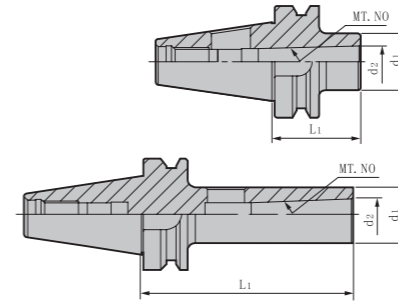

订货号 Ordering Code	莫氏锥度 MT.NO	尺寸 Dimension (mm)			重量 Weight (kg)	
		d1	d2	L1		
BT30-	MTA1-45	1	25	12.065	45	0.55
	MTA1-105	1	25	12.065	105	0.80
	MTA2-60	2	32	17.78	60	0.60
	MTA2-120	2	32	17.78	120	0.90
	MTA3-80	3	40	23.825	80	0.80
BT40-	MTA1-45	1	25	12.065	45	1.05
	MTA1-120	1	25	12.065	120	1.28
	MTA2-50	2	32	17.78	50	1.00
	MTA2-120	2	32	17.78	120	1.41
	MTA3-70	3	40	23.825	70	1.13
	MTA3-135	3	40	23.825	135	1.75
	MTA4-95	4	48	31.267	95	1.35
	MTA4-165	4	48	31.267	165	2.30
BT50-	MTA1-45	1	25	12.065	45	3.59
	MTA1-120	1	25	12.065	120	3.88
	MTA1-180	1	25	12.065	180	4.12
	MTA2-60	2	32	17.78	60	3.64
	MTA2-135	2	32	17.78	135	4.17
	MTA2-180	2	32	17.78	180	4.39
	MTA3-65	3	40	23.825	65	3.60
	MTA3-150	3	40	23.825	150	4.40
	MTA3-180	3	40	23.825	180	4.73
	MTA4-95	4	48	31.267	95	3.88
	MTA4-180	4	48	31.267	180	5.00
	MTA5-105	5	63	44.399	105	3.74

### BT-MTB莫氏锥套刀柄 ( 螺丝锁紧 )

BT-MTB Morse Taper Holder

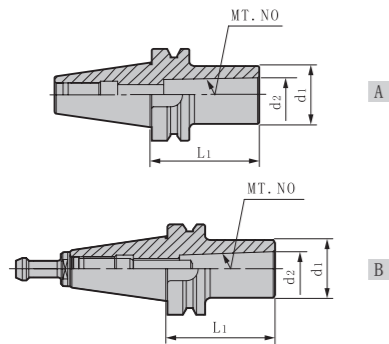

订货号 Ordering Code	莫氏锥度 MT.NO	图示 Figure	尺寸 Dimension ( mm )			范围 Range ( mm )	重量 Weight ( kg )	
			d1	d2	L1			
BT30-	MTB1-45	1	A	25	12.065	45	Φ10-Φ14	0.55
	MTB2-60	2	B	32	17.78	60	Φ16-Φ22	0.60
BT40-	MTB1-45	1	A	25	12.065	45	Φ10-Φ14	1.00
	MTB2-50	2	A	32	17.78	50	Φ16-Φ22	1.02
	MTB3-75	3	B	40	23.825	75	Φ24-Φ32	1.19
	MTB4-90	4	B	48	31.267	90	Φ32-Φ50	1.33
BT50-	MTB1-45	1	A	25	12.065	45	Φ10-Φ14	3.30
	MTB2-45	2	A	32	17.78	45	Φ16-Φ22	3.57
	MTB3-60	3	A	40	23.825	60	Φ24-Φ32	3.61
	MTB4-75	4	A	50	31.267	75	Φ32-Φ50	3.68
	MTB5-120	5	B	70	44.399	120	Φ55-Φ60	4.10

注：报价时含拉紧螺钉。  
Notice: Tension screw is included.

### BT-GPU整体式钻夹头刀柄

BT-GPU Drill Chuck Holder

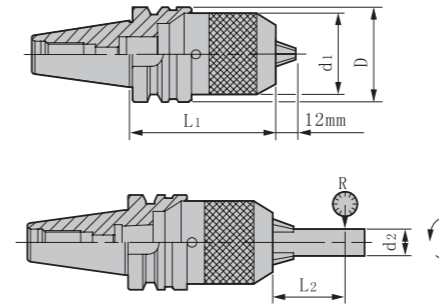

订货号 Ordering Code	尺寸 Dimension ( mm )					偏摆精度 R ( mm )	范围 Range ( mm )	重量 Weight ( kg )	
	D	d1	d2	L1	L2				
BT30-	GPU8-80	46	37	8	80	55	0.04	0-8	0.72
	GPU13-110	46	50	13	110	75	0.04	0.3-13	1.62
	GPU16-120	46	57	16	120	80	0.04	3-16	1.70
BT40-	GPU8-85	63	37	8	85	55	0.04	0-8	1.36
	GPU13-100	63	50	13	100	75	0.04	0.3-13	1.76
	GPU13-130	63	50	13	130	75	0.04	0.3-13	2.47
	GPU16-105	63	57	16	105	80	0.04	3-16	2.18
BT50-	GPU8-90	100	37	8	90	55	0.04	0-8	4.32
	GPU13-100	100	50	13	100	75	0.04	0.3-13	4.98
	GPU13-130	100	50	13	130	75	0.04	0.3-13	5.50
	GPU13-180	100	50	13	180	75	0.04	0.3-13	6.06
	GPU16-105	100	57	16	105	80	0.04	3-16	4.78
	GPU16-130	100	57	16	130	80	0.04	3-16	5.24
	GPU16-190	100	57	16	190	80	0.04	3-16	6.66

注：报价时含扳手。  
Notice: Wrench is included.

### BT-FMA平面铣刀柄 (直柄式)

BT-FMA Face Mill Holder

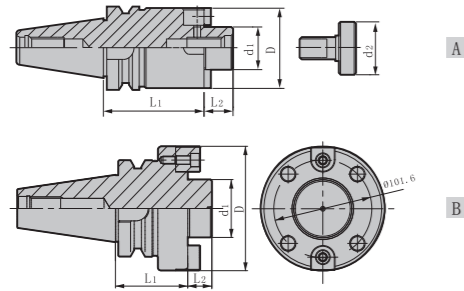

订货号 Ordering Code	图示 Figure	尺寸 Dimension (mm)					压紧螺钉 Screw	重量 Weight (kg)	
		D	d1	d2	L1	L2			
BT30-	FMA25.4-45	A	50	25.4	31.5	45	20	SCAM120300	1.10
	FMA25.4-60	A	50	25.4	31.5	60	20	SCAM120300	1.30
	FMA31.75-45	A	60	31.75	40	45	22	SCAM160350	1.35
BT40-	FMA25.4-45	A	50	25.4	31.5	45	20	SCAM120300	1.54
	FMA25.4-60	A	50	25.4	31.5	60	20	SCAM120300	1.77
	FMA25.4-90	A	50	25.4	31.5	90	20	SCAM120300	2.23
	FMA25.4-105	A	50	25.4	31.5	105	20	SCAM120300	2.47
	FMA31.75-45	A	60	31.75	40	45	22	SCAM160350	1.65
	FMA31.75-75	A	60	31.75	40	75	22	SCAM160350	2.31
	FMA31.75-90	A	60	31.75	40	90	22	SCAM160350	2.64
	FMA38.10-60	A	75	38.1	50	60	25	SCAM160350	2.36
	FMA50.80-60	A	95	50.8	65	60	36	SCAM240350-65	3.50
	BT50-	FMA25.4-45	A	50	25.4	31.5	45	20	SCAM120300
FMA25.4-90		A	50	25.4	31.5	90	20	SCAM120300	4.54
FMA25.4-150		A	50	25.4	31.5	150	20	SCAM120300	5.47
FMA31.75-45		A	60	31.75	40	45	22	SCAM160350-40	4.04
FMA31.75-75		A	60	31.75	40	75	22	SCAM160350-40	4.72
FMA31.75-105		A	98	31.75	40	105	22	SCAM160350-40	7.19
FMA38.10-45		A	80	38.1	50	45	25	SCAM160350-50	4.27
FMA38.10-75		A	80	38.1	50	75	25	SCAM160350-50	5.48
FMA50.80-45		A	95	50.8	65	45	36	SCAM240350-65	4.74
FMA50.80-75		A	95	50.8	65	75	36	SCAM240350-65	6.35
FMA47.625F-75		B	128.75	47.625	-	75	32	SCAM160500	7.60

### BT-FMB平面铣刀柄 (直柄式)

BT-FMB Face Mill Holder

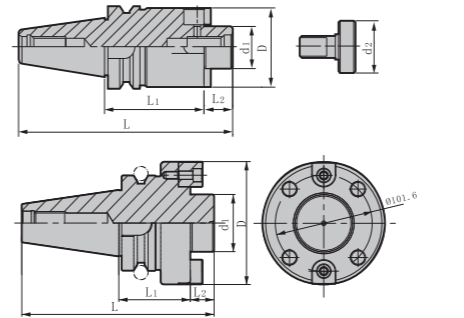

订货号 Ordering Code	图示 Figure	尺寸 Dimension (mm)					压紧螺钉 Screw	重量 Weight (kg)	
		D	d1	d2	L1	L2			
BT30-	FMB22-45	A	48	22	16	45	18	SCAM100300	0.85
	FMB22-60	A	48	22	16	60	18	SCAM100300	1.25
	FMB27-45	A	60	27	33	45	20	SCAM120300	1.20
	FMB27-60	A	60	27	33	60	20	SCAM120300	1.35
	FMB32-45	A	78	32	40	45	22	SCAM160350	1.35
BT40-	FMB22-45	A	48	22	16	45	18	SCAM100300	1.31
	FMB22-60	A	48	22	16	60	18	SCAM100300	1.51
	FMB22-90	A	48	22	16	90	18	SCAM100300	1.94
	FMB22-150	A	48	22	16	150	18	SCAM100300	2.70
	FMB22-200	A	48	22	16	200	18	SCAM100300	3.43
	FMB27-45	A	60	27	33	45	20	SCAM100300	1.52
	FMB27-60	A	60	27	33	60	20	SCAM120300	1.86
	FMB27-90	A	60	27	33	90	20	SCAM120300	2.51
	FMB27-105	A	60	27	33	105	20	SCAM120300	2.86
	FMB32-45	A	78	32	40	45	22	SCAM120300	1.87
BT50-	FMB32-60	A	78	32	40	60	22	SCAM160350	2.32
	FMB40-60	A	85	40	50	60	25	SCAM160350	2.47
	FMB22-45	A	48	22	16	45	18	SCAM160350	3.79
	FMB22-90	A	48	22	16	90	18	SCAM100300	4.53
	FMB22-150	A	48	22	16	150	18	SCAM100300	5.27
	FMB22-200	A	48	22	16	200	18	SCAM100300	5.97
	FMB22-250	A	48	22	16	250	18	SCAM100300	6.69
	FMB22-300	A	48	22	16	300	18	SCAM100300	7.42
	FMB22-350	A	48	22	16	350	18	SCAM100300	8.13
	FMB22-400	A	48	22	16	400	18	SCAM100300	8.83
	FMB27-50	A	60	27	33	50	20	SCAM100300	4.04
	FMB27-90	A	60	27	33	90	20	SCAM120300	4.94
	FMB27-150	A	60	27	33	150	20	SCAM120300	6.25
	FMB27-200	A	60	27	33	200	20	SCAM120300	7.37

### BT-FMB平面铣刀柄 (直柄式)

BT-FMB Face Mill Holder

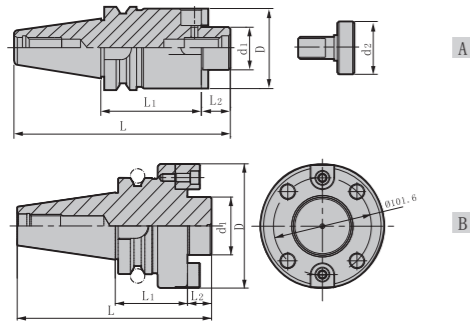

订货号 Ordering Code	图示 Figure	尺寸 Dimension ( mm )						压紧螺钉 Screw	重量 Weight ( kg )
		D	d1	d2	L1	L2			
FMB27-250	A	60	27	33	250	20	SCAM120300	8.51	
FMB32-50	A	78	32	40	50	22	SCAM160350-40	4.40	
FMB32-90	A	78	32	40	90	22	SCAM160350-40	5.79	
FMB32-150	A	78	32	40	150	22	SCAM200350-50	7.10	
FMB40-50	A	85	40	50	50	25	SCAM200350-50	4.57	
FMB40-90	A	85	40	50	90	25	SCAM200350-50	6.45	
FMB40-105	A	85	40	50	105	25	SCAM200350-50	7.02	
FMB60F-75	B	140	60	-	75	25	SCAM160500	8.00	

### BT-TPN扭力伸缩攻牙刀柄

BT-TPN Tapping Chuck

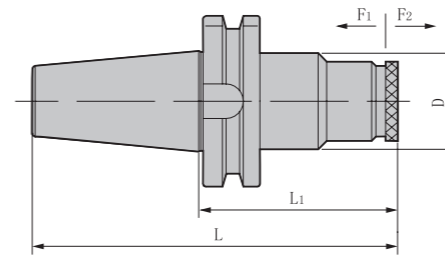

订货号 Ordering Code	尺寸 Dimension ( mm )						适用筒夹 Suit Collet	攻牙范围 Tapping Range ( mm )	重量 Weight ( kg )
	D	F1	F2	L1	L				
BT30-	TPN316	50	10	20	111.6	162	TPD316	M3-M16	0.75
	TPN830	66	10	25	148.6	199	TPD830	M8-M30	0.80
BT40-	TPN316	50	10	20	101	168	TPD316	M3-M16	1.56
	TPN830	66	10	25	141	208	TPD830	M8-M30	2.62
BT50-	TPN316	50	10	20	118	222.8	TPD316	M3-M16	4.24
	TPN830	66	10	25	130.2	235	TPD830	M8-M30	4.77

注：筒夹需单独订购。  
Notice: Collets shall be ordered separately.



### BT-VER同步微补偿攻牙刀柄 BT-VER Tapping Chuck

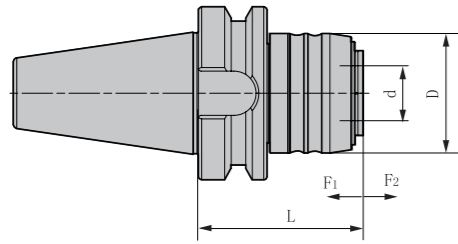

订货号 Ordering Code	尺寸 Dimension ( mm )					攻牙范围 Tapping Range ( mm )	延长杆 Extender	重量 Weight ( kg )	
	D	d	L	F1	F2				
BT40-	VER16-61	43.5	20	61	0.2	1	M3-M12	V20-ER16	1.05
	VER20-72	52	25	72	0.2	1	M5-M16	V25-ER20	1.20
	VER25-82	60	32	82	0.2	1	M6-M20	V32-ER25	1.35
	VER32-98	72	40	98	0.2	1	M10-M24	V40-ER32	1.68
	VER40-107	87	50	107	0.2	1	M14-M33	V50-ER40	1.95
BT50-	VER16-72	43.5	20	72	0.2	1	M3-M12	V20-ER16	3.55
	VER20-72	52	25	83	0.2	1	M5-M16	V25-ER20	3.45
	VER25-93	60	32	93	0.2	1	M6-M20	V32-ER25	3.88
	VER32-98	72	40	109	0.2	1	M10-M24	V40-ER32	4.22
	VER40-107	87	50	124	0.2	1	M14-M33	V50-ER40	4.65



HSK TOOLING SYSTEM  
HSK 工具系统

B

### HSK-A-GHP 液压刀柄

HSK-A-GHP Hydraulic Chuck

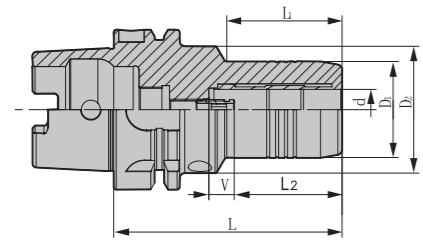

订货号 Ordering Code	尺寸 Dimension ( mm )							适用筒夹 Suit Collet	扳手 Wrench	重量 Weight ( kg )	
	d	D1	D2	L2	V	L1	L				
HSK40A-	GHP6-70	6	28	34	27.5	10	28	70	-	TH04T	0.55
	GHP8-70	8	30	34	27.5	10	28	70	-	TH04T	0.56
	GHP10-75	10	32	34	32.5	10	34	75	-	TH04T	0.61
	GHP12-85	12	34	34	37.5	10	-	85	D12/OD12	TH04T	0.68
HSK50A-	GHP6-70	6	28	40	27.5	10	28	70	-	TH04T	0.74
	GHP8-70	8	30	40	27.5	10	28	70	-	TH04T	0.75
	GHP10-75	10	32	40	32.5	10	34	75	-	TH04T	0.82
	GHP12-85	12	34	40	37.5	10	44	85	D12/OD12	TH04T	0.87
	GHP14-85	14	36	40	37.5	10	44	85	-	TH04T	0.90
	GHP16-90	16	38	60	42.5	10	30	90	-	TH04T	0.94
	GHP18-90	18	41	-	42.5	10	-	90	-	TH04T	0.96
HSK63A-	GHP20-90	20	42	-	42.5	10	-	90	D20/OD20	TH04T	0.99
	GHP6-70	6	28	50	27.5	10	24	70	--	TH04T	1.01
	GHP8-70	8	30	50	27.5	10	24	70	-	TH04T	1.02
	GHP10-80	10	32	50	32.5	10	35	80	-	TH04T	1.08
	GHP12-85	12	34	50	37.5	10	40	85	D12/OD12	TH04T	1.13
	GHP14-85	14	36	50	37.5	10	40	85	-	TH04T	1.17
	GHP16-90	16	38	50	42.5	10	46	90	-	TH04T	1.21
	GHP18-90	18	41	50	42.5	10	47	90	-	TH04T	1.22
	GHP20-90	20	43	50	42.5	10	48	90	D20/OD20	TH04T	1.25
	GHP25-120	25	57	63	51	10	59	120	-	TH05T	2.17
HSK100A-	GHP32-125	32	63	75	55	10	63	125	D32/OD32	TH05T	2.54
	GHP6-75	6	28	54	27.5	10	26	75	-	TH04T	2.4
	GHP8-75	8	30	54	27.5	10	26	75	-	TH04T	2.41
	GHP10-90	10	32	50	32.5	10	42	90	-	TH04T	2.48
	GHP12-95	12	34	50	37.5	10	47	95	D12/OD12	TH04T	2.53
	GHP14-95	14	36	50	37.5	10	47	95	-	TH04T	2.58
	GHP16-100	16	38	50	42.5	10	53	100	-	TH04T	2.61
	GHP18-100	18	41	50	42.5	10	53	100	-	TH04T	2.66
	GHP20-105	20	43	50	42.5	10	59	105	D20/OD20	TH04T	2.75
	GHP25-120	25	57	63	51	10	62	120	-	TH05T	3.39
GHP32-125	32	63	75	55	10	62	125	D32/OD32	TH05T	3.66	

注：报价时会扳手，筒夹需单独订购。  
Notice: Wrench is included, while collet shall be ordered separately.

### HSK-A-SF热缩刀柄

HSK-A-SF Shrink Fit Holder

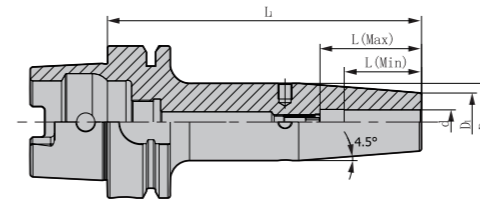

订货号 Ordering Code	尺寸 Dimension ( mm )						重量 Weight ( kg )
	d	D1	D2	L1	L(Max)	L(Min)	
SF3-80	3	10	10	80	-	9	0.50
SF4-80	4	10	10	80	-	12	0.60
SF5-80	5	10	10	80	-	15	0.70
SF6-80	6	21	27	80	28	18	0.80
SF6-130	6	21	27	130	28	18	1.00
SF6-160	6	21	27	160	28	18	1.20
SF8-80	8	21	27	80	34	24	0.80
SF8-130	8	21	27	130	34	24	1.02
SF8-160	8	21	27	160	34	24	1.25
SF10-85	10	24	32	85	40	30	0.90
SF10-130	10	24	32	130	40	30	1.17
SF10-160	10	24	32	160	40	30	1.45
SF12-90	12	24	32	90	40	30	0.92
SF12-130	12	24	32	130	40	30	1.15
SF12-160	12	24	32	160	40	30	1.55
HSK63A-	SF14-90	14	27	34	90	42	0.95
	SF14-130	14	27	34	130	42	1.18
	SF14-160	14	27	34	160	42	1.60
	SF16-95	16	27	34	95	42	1.00
	SF16-130	16	27	34	130	42	1.21
	SF16-160	16	27	34	160	42	1.65
	SF18-95	18	33	42	95	50	1.05
	SF18-130	18	33	42	130	50	1.25
	SF18-160	18	33	42	160	50	1.70
	SF20-100	20	33	42	100	50	1.20
SF20-130	20	33	42	130	50	1.49	
SF20-160	20	33	42	160	50	1.80	
SF25-115	25	44	53	115	55	1.98	
SF25-160	25	44	53	160	55	2.10	
SF32-120	32	44	53	120	60	2.10	
SF32-160	32	44	53	160	60	2.60	

## HSK-A-SF热缩刀柄

HSK-A-SF Shrink Fit Holder

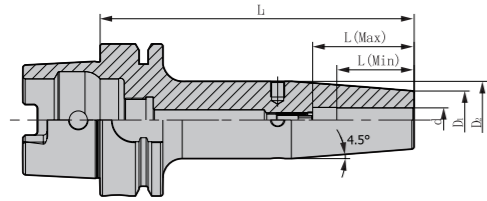

订货号 Ordering Code	尺寸 Dimension ( mm )						重量 Weight ( kg )
	d	D1	D2	L1	L(Max)	L(Min)	
HSK100A-SF6-85	6	21	27	85	28	18	2.00
HSK100A-SF6-130	6	21	27	130	28	18	2.30
HSK100A-SF6-160	6	21	27	160	28	18	2.62
HSK100A-SF8-85	8	21	27	85	34	24	2.00
HSK100A-SF8-130	8	21	27	130	34	24	2.30
HSK100A-SF8-160	8	21	27	160	34	24	2.65
HSK100A-SF10-90	10	24	32	90	40	30	2.20
HSK100A-SF10-130	10	24	32	130	40	30	2.40
HSK100A-SF10-160	10	24	32	160	40	30	2.70
HSK100A-SF12-95	12	24	32	95	40	30	2.30
HSK100A-SF12-130	12	24	32	130	40	30	2.50
HSK100A-SF12-160	12	24	32	160	40	30	2.75
HSK100A-SF14-95	14	27	34	95	42	32	2.35
HSK100A-SF14-130	14	27	34	130	42	32	2.60
HSK100A-SF14-160	14	27	34	160	42	32	2.85
HSK100A-SF16-100	16	27	34	100	42	32	2.50
HSK100A-SF16-130	16	27	34	130	42	32	2.80
HSK100A-SF16-160	16	27	34	160	42	32	3.13
HSK100A-SF18-100	18	33	42	100	50	40	2.55
HSK100A-SF18-130	18	33	42	130	50	40	2.85
HSK100A-SF18-160	18	33	42	160	50	40	3.21
HSK100A-SF20-105	20	33	42	105	50	40	2.60
HSK100A-SF20-130	20	33	42	130	50	40	2.90
HSK100A-SF20-160	20	33	42	160	50	40	3.25
HSK100A-SF25-115	25	44	53	115	55	45	2.80
HSK100A-SF25-160	25	44	53	160	55	45	3.40
HSK100A-SF32-120	32	44	53	120	60	50	3.20
HSK100A-SF32-160	32	44	53	160	60	50	3.60

特点 / Feature  
 • 动平衡设定: G2.5; 25,000 rpm.  
 Balanced: G2.5; 25,000 rpm.  
 • 3D处径向跳动0.003mm以下。  
 Runout(X3D) ≤ 0.003mm.

## HSK-A-GSK高速精密筒夹刀柄

HSK-A-GSK High Precision Chuck

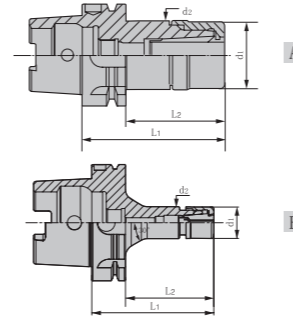

订货号 Ordering Code	图示 Figure	尺寸 Dimension ( mm )				适用筒夹 Suit Collet	重量 Weight ( kg )	
		d1	d2	L	L1			
HSK40A-	GSK6-60	A	19.5	20	60	40	DSK6	0.47
	GSK10-75	A	27	27.5	75	55	DSK10	0.5
HSK50A-	GSK6-60	A	19.5	20	60	34	DSK6	0.60
	GSK6-80	A	19.5	20	80	54	DSK6	0.80
	GSK10-75	A	27	27.5	75	49	DSK10	1.00
	GSK10-100	A	27	27.5	100	74	DSK10	1.20
HSK63A-	GSK16-80	A	40	40.5	80	54	DSK16	1.75
	GSK16-100	A	40	40.5	100	74	DSK16	2.00
	GSK20-100	A	48	48.5	100	74	DSK20	2.10
	GSK6-80P	A	19.5	20	80	54	DSK6	0.85
	GSK6-100	A	19.5	20	100	74	DSK6	0.95
	GSK10-75	A	27	27.5	75	49	DSK10	1.00
	GSK10-100	A	27	27.5	100	74	DSK10	1.40
	GSK16-80	A	40	40.5	80	54	DSK16	2.00
	GSK16-100	A	40	40.5	100	74	DSK16	2.30
	GSK16-120	A	40	40.5	120	94	DSK16	2.50
HSK100A-	GSK20-100	A	48	48.5	100	74	DSK20	2.45
	GSK20-120	A	48	48.5	120	94	DSK20	2.65
	GSK25-100	A	55	55	100	74	DSK25	2.30
	GSK10-105	B	27	27.5	105	76	DSK10	2.60
	GSK10-135	B	27	27.5	135	106	DSK10	2.80
	GSK16-105	A	40	40.5	105	76	DSK16	2.80
	GSK16-135	A	40	40.5	135	106	DSK16	3.10
	GSK20-120	A	48	48.5	120	91	DSK20	3.00
	GSK20-150	A	48	48.5	150	121	DSK20	3.30
	GSK25-120	A	55	55	120	91	DSK25	3.20
GSK25-150	A	55	55	150	121	DSK25	3.50	

注: 筒夹与扳手需单独另购, 中心水螺帽与端面出水螺帽详见配件。  
 Notice: Collets and wrenches shall be orderer separately, internal-cooling nuts and flange-cooling nuts see appendix for details.

特点 / Feature  
 • 动平衡设定: G2.5; 25,000 rpm.  
 Balanced: G2.5; 25,000 rpm.  
 • 3D处径向跳动0.003mm以下。  
 Runout(X3D) ≤ 0.003mm.

## HSK-A-HPC高速精密强力铣刀柄

HSK-A-HPC High Speed Milling Chuck

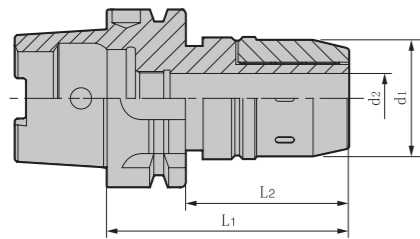

订货号 Ordering Code	夹持范围 Range(mm)	尺寸 Dimension ( mm )				适用筒夹 Suit Collet	重量 Weight ( kg )	
		d1	d2	L1	L2			
HSK63A-	HPC20-110	6-20	51.5	20	110	84	GC20	1.60
	HPC32-110	6-32	70.5	32	110	84	GC32	2.20
HSK100A-	HPC20-105	6-20	51.5	20	105	79	GC20	4.10
	HPC32-105	6-32	70.5	32	105	79	GC32	4.90
	HPC32-135	6-32	70.5	32	135	109	GC32	5.80
	HPC42-115	6-42	86	42	115	89	GC42	5.50

注：报价时含扳手，筒夹需单独订购  
Notice: Wrench is included, while collet is to be ordered separately.

特点 / Feature  
 • 动平衡设定: G6.3 ; 15,000 rpm.  
 Balanced: G6.3; 15,000 rpm.  
 • 3D处径向跳动0.02mm以下。  
 Runout(X3D) ≤0.02mm.

## HSK-A-ER弹性筒夹刀柄

HSK-A-ER Spring Collet Chuck

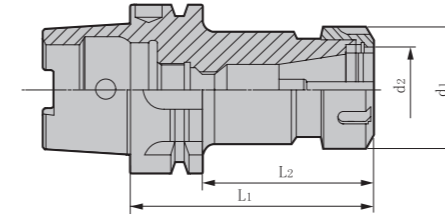

订货号 Ordering Code	尺寸 Dimension ( mm )				重量 Weight ( kg )	
	d1	d2	L1	L2		
HSK40A-	ER20-80	34	20	80	60	0.55
	ER25-80	42	25	80	60	0.65
HSK50A-	ER32-100	50	32	100	80	0.90
	ER16-75	28	16	75	34	0.50
	ER16-100	28	16	100	74	0.60
	ER20-75	34	20	75	44	0.70
	ER20-100	34	20	100	74	0.90
	ER25-80	42	25	80	44	1.00
	ER25-100	42	25	100	74	1.10
	ER25-135	42	25	135	109	1.40
	ER32-100	50	32	100	74	1.45
	ER32-135	50	32	135	109	1.90
	ER32-160	50	32	160	134	2.40
	HSK63A-	ER16-75	28	16	75	49
ER16-100		28	16	100	74	1.10
ER16-120		28	16	120	94	1.20
ER16-160		28	16	160	134	1.40
ER20-80		34	20	80	49	1.00
ER20-100		34	20	100	74	1.20
ER20-120		34	20	120	94	1.30
ER20-160		34	20	160	134	1.70
ER25-80		42	25	80	49	1.10
ER25-100		42	25	100	74	1.40
ER25-120		42	25	120	94	1.80
ER25-150		42	25	150	124	2.00
HSK63A-	ER32-100	50	32	100	74	1.60
	ER32-125	50	32	125	99	2.00
	ER32-160	50	32	160	134	2.50
	ER40-100	63	40	100	74	2.40
	ER40-120	63	40	120	94	2.60
	ER40-160	63	40	160	134	2.95

## HSK-A-ER弹性筒夹刀柄

HSK-A-ER Spring Collet Chuck

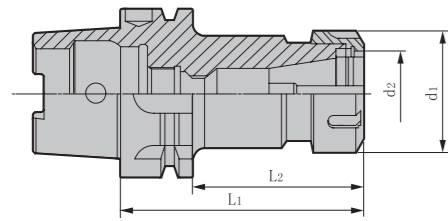

订货号 Ordering Code	尺寸 Dimension ( mm )				重量 Weight ( kg )	
	d1	d2	L1	L2		
HSK100A-	ER16-100	28	16	100	71	3.40
	ER16-160	28	16	160	131	3.70
	ER20-100	34	20	100	71	3.50
	ER20-160	34	20	160	131	3.90
	ER25-100	42	25	100	71	3.70
	ER25-160	42	25	160	131	4.20
	ER25-200	42	25	200	171	4.70
	ER32-100	50	32	100	71	3.90
	ER32-160	50	32	160	131	4.70
	ER32-200	50	32	200	171	5.20
	ER40-100	63	40	100	71	4.30
	ER40-160	63	40	160	131	5.00
	ER40-200	63	40	200	171	5.60

注：筒夹和扳手需单独订购  
Notice: Collets and wrenches shall be ordered separately.

特点 / Feature  
 • 动平衡设定：G6.3；15,000 rpm.  
 Balanced: G6.3; 15,000 rpm.  
 • 3D处径向跳动0.02mm以下。  
 Runout(X3D) ≤ 0.02mm.

## HSK-A-GLN侧固式刀柄

HSK-A-GLN Side-lock Holder

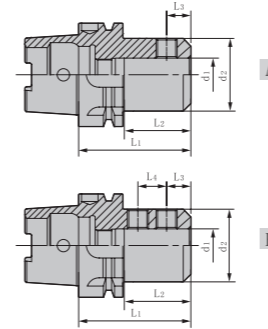

订货号 Ordering Code	图示 Figure	尺寸 Dimension ( mm )						侧固螺钉 Screw	重量 Weight ( kg )	
		d1	d2	L1	L2	L3	L4			
HSK50A-	GLN6-65	A	6	25	65	39	18	-	STBM060100	0.70
	GLN8-65	A	8	28	65	39	18	-	STBM080100	0.80
	GLN10-65	A	10	35	65	39	20	-	STBM100120	0.80
	GLN12-80	A	12	42	80	54	22.5	-	STBM120140	1.20
	GLN16-80	A	16	48	80	54	24	-	STBM140160	1.30
	GLN20-80	A	20	52	80	54	25	-	STBM160160	1.50
HSK63A-	GLN6-65	A	6	25	65	39	18	-	STBM060100	0.90
	GLN6-100	A	6	25	100	74	18	-	STBM060100	1.30
	GLN8-65	A	8	28	65	39	18	-	STBM080100	1.00
	GLN8-100	A	8	28	100	74	18	-	STBM080100	1.40
	GLN10-65	A	10	35	65	39	20	-	STBM100120	1.00
	GLN10-100	A	10	35	100	74	20	-	STBM100120	1.50
	GLN12-80	A	12	42	80	54	22.5	-	STBM120140	1.70
	GLN12-120	A	12	42	120	94	22.5	-	STBM120140	2.00
	GLN16-80	A	16	48	80	54	24	-	STBM140160	1.70
	GLN16-120	A	16	48	120	94	24	-	STBM140160	2.10
	GLN20-80	A	20	52	80	54	25	-	STBM160160	1.80
	GLN20-120	A	20	52	120	94	25	-	STBM160160	2.40
	GLN25-110	B	25	65	110	84	24	25	STCM180200	2.50
	GLN25-160	B	25	65	160	134	24	25	STCM180200	2.65
	GLN32-110	B	32	72	110	84	24	28	STCM200180	2.70
GLN32-160	B	32	72	160	134	24	28	STCM200180	3.00	

## HSK-A-GLN侧固式刀柄

HSK-A-GLN Side-lock Holder

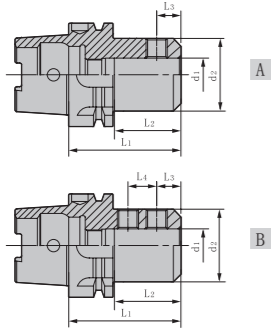

订货号 Ordering Code	图示 Figure	尺寸 Dimension (mm)							侧固螺钉 Screw	重量 Weight (kg)
		d1	d2	L1	L2	L3	L4			
GLN6-80	A	6	25	80	51	18	-	STBM060100	3.00	
GLN6-130	A	6	25	130	131	18	-	STBM060100	3.20	
GLN8-80	A	8	25	80	51	18	-	STBM080100	3.20	
GLN8-130	A	8	25	130	131	18	-	STBM080100	3.40	
GLN10-80	A	10	35	80	51	20	-	STBM100120	3.40	
GLN10-130	A	10	35	130	131	20	-	STBM100120	3.70	
GLN12-80	A	12	42	80	51	22.5	-	STBM120140	3.40	
GLN12-130	A	12	42	130	131	22.5	-	STBM120140	3.70	
GLN16-100	A	16	48	100	71	24	-	STBM140160	3.80	
GLN16-160	A	16	48	160	71	24	-	STBM140160	4.10	
GLN20-100	A	20	52	100	71	25	-	STBM160160	3.90	
GLN20-160	A	20	52	160	71	25	-	STBM160160	3.80	
GLN25-100	B	25	65	100	71	24	25	STCM180200	4.00	
GLN25-160	B	25	65	160	71	24	25	STCM180200	4.40	
GLN32-100	B	32	72	100	71	24	28	STCM200180	4.10	
GLN32-160	B	32	72	160	71	24	28	STCM200180	4.50	

注：扳手需单独订购。  
Notice: Wrenchs shall be ordered separately.

## HSK-A-GLNB侧固式刀柄

HSK-A-GLNB Side-lock Holder

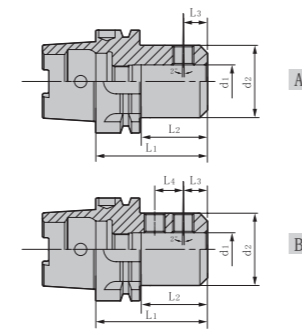

订货号 Ordering Code	图示 Figure	尺寸 Dimension (mm)							侧固螺钉 Screw	重量 Weight (kg)
		d1	d2	L1	L2	L3	L4			
GLNB6-80	A	6	25	80	54	18	-	STCM060100	0.90	
GLNB8-80	A	8	28	80	54	18	-	STCM080100	1.00	
GLNB10-80	A	10	35	80	54	20	-	STCM100120	1.00	
GLNB12-90	A	12	42	90	64	22.5	-	STCM120140	1.70	
GLNB16-100	A	16	48	100	74	24	-	STCM140160	1.70	
GLNB20-100	A	20	52	100	74	25	-	STCM160160	1.80	
GLNB25-110	B	25	65	110	84	24	22	STBM180200	2.50	
GLNB32-110	B	32	72	110	84	24	24	STBM200180	2.70	
GLNB6-90	A	6	25	90	61	18	-	STCM060080	3.00	
GLNB8-90	A	8	28	90	61	18	-	STCM080080	3.20	
GLNB10-90	A	10	35	90	61	20	-	STCM100120	3.40	
GLNB12-100	A	12	42	100	71	22.5	-	STCM120140	3.40	
GLNB16-100	A	16	48	100	71	24	-	STCM140160	3.80	
GLNB20-110	A	20	52	110	81	25	-	STCM160160	3.90	
GLNB25-120	B	25	65	120	91	24	22	STBM180200	4.00	
GLNB32-120	B	32	72	120	91	24	24	STBM200180	4.10	

注：扳手需单独订购。  
Notice: Wrenchs shall be ordered separately.

### HSK-A-MTA莫式锥套刀柄 (钻头套筒)

HSK-A-MTA Morse Taper Adapter

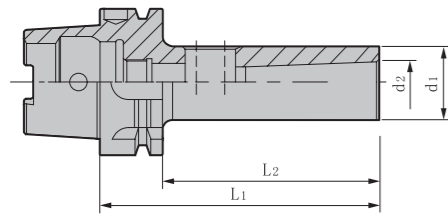

订货号 Ordering Code	尺寸 Dimension (mm)				重量 Weight (kg)	
	d1	d2	L1	L2		
HSK50A-	MTA1-100	25	12.065	100	74	1.50
	MTA2-120	32	17.78	120	94	1.80
	MTA3-140	40	23.825	140	114	1.90
HSK63A-	MTA1-100	25	12.065	100	74	1.90
	MTA2-120	32	17.78	120	94	2.00
	MTA3-140	40	23.825	140	114	2.20
	MTA4-160	48	31.267	160	134	2.50
HSK100A-	MTA1-110	25	12.065	110	81	3.40
	MTA2-120	32	17.78	120	91	3.80
	MTA3-150	40	23.825	150	121	4.00
	MTA4-170	48	31.267	170	141	4.60
	MTA5-200	63	44.299	200	171	5.20

### HSK-A-GPU整体式钻夹头刀柄

HSK-A-GPU Drill Chuck Holder

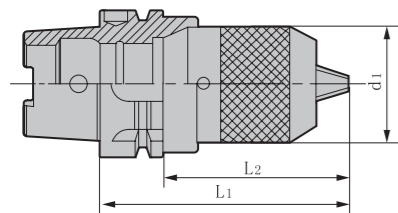

订货号 Ordering Code	尺寸 Dimension (mm)				跳动精度 3D (mm)	重量 Weight (kg)	
	d1	d2	L1	L2			
HSK50A-	GPU8-120	50	8	120	100	0.05	1.61
HSK63A-	GPU13-150	50	13	150	124	0.05	2.65
	GPU16-155	57	16	155	129	0.05	3.12
HSK100A-	GPU13-155	50	13	155	126	0.05	4.23
	GPU16-160	57	16	160	131	0.05	4.55

注：报价时含扳手。  
Notice: Wrench is included.

### HSK-A-FMB平面铣刀柄

HSK-A-FMB Face Mill Holder

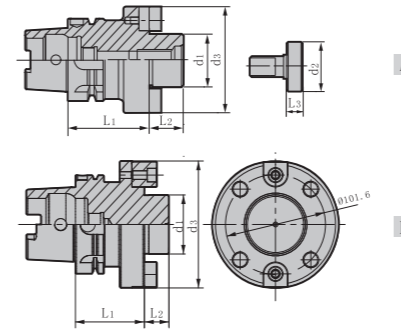

订货号 Ordering Code	图示 Figure	尺寸 Dimension (mm)							压紧螺钉 Screw	重量 Weight (kg)
		d1	d2	d3	L1	L2	L3			
HSK50A-	FMB22-60	A	22	26	48	60	18	14	SCAM100300	1.00
	FMB27-60	A	27	31.5	60	60	20	16	SCAM120300	1.10
HSK63A-	FMB22-50	A	22	26	48	50	18	-	SCAM100300	1.30
	FMB22-100	A	22	26	48	100	18	-	SCAM100300	1.80
	FMB27-60	A	27	31.5	60	60	20	16	SCAM120300	1.60
	FMB27-100	A	27	31.5	60	100	20	16	SCAM120300	2.30
	FMB32-60	A	32	41	78	60	22	16	SCAM160350	2.00
	FMB32-100	A	32	41	78	100	22	16	SCAM160350	2.80
HSK100A-	FMB40-60	A	40	48	80	60	25	20.5	SCAM160350	2.20
	FMB22-50	A	22	26	48	50	18	14	SCAM100300	2.90
	FMB22-100	A	22	26	48	100	18	14	SCAM100300	3.90
	FMB27-50	A	27	31.5	60	50	20	16	SCAM120300	2.90
	FMB27-100	A	27	31.5	60	100	20	16	SCAM120300	3.70
	FMB32-50	A	32	41	78	50	22	16	SCAM160350-40	3.80
	FMB32-100	A	32	41	78	100	22	16	SCAM160350-40	4.80
	FMB40-60	A	40	48	80	60	25	20.5	SCAM200350-50	4.10
	FMB40-100	A	40	48	80	100	25	20.5	SCAM200350-50	4.90
	FMB60F-70	B	60	-	129	70	25	101.6	SCAM160500	5.50

## HSK-A-VER同步微补偿攻牙刀柄

HSK-A-VER Tapping Chuck

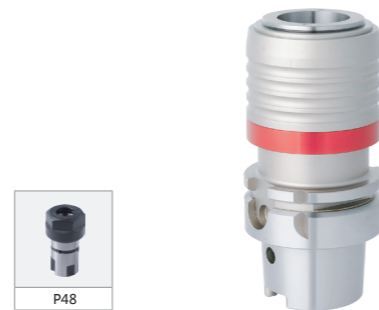
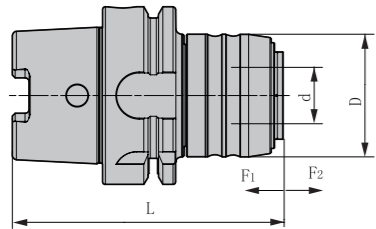

订货号 Ordering Code	尺寸 Dimension ( mm )					攻牙范围 Tapping Range ( mm )	延长杆 Extender	重量 Weight ( kg )	
	D	d	L	F1	F2				
HSK40A	VER16-69	43.5	20	69	0.2	1	M3-M12	V20-ER16	0.54
	VER20-80	52	25	80	0.2	1	M5-M16	V25-ER20	0.59
	VER25-90	60	32	90	0.2	1	M6-M20	V32-ER25	0.65
HSK50A-	VER16-70	43.5	20	70	0.2	1	M3-M12	V20-ER16	0.66
	VER20-87	52	25	87	0.2	1	M5-M16	V25-ER20	0.80
	VER25-97	60	32	97	0.2	1	M6-M20	V32-ER25	0.96
HSK63A-	VER16-64	43.5	20	64	0.2	1	M3-M12	V20-ER16	0.88
	VER20-87	52	25	87	0.2	1	M5-M16	V25-ER20	1.06
	VER25-97	60	32	97	0.2	1	M6-M20	V32-ER25	1.21
	VER32-113	72	40	113	0.2	1	M10-M24	V40-ER32	1.61
HSK100A-	VER40-122	87	50	122	0.2	1	M14-M33	V50-ER40	1.85
	VER16-70	43.5	20	70	0.2	1	M3-M12	V20-ER16	3.21
	VER20-82	52	25	82	0.2	1	M5-M16	V25-ER20	3.58
	VER25-91	60	32	91	0.2	1	M6-M20	V32-ER25	3.95
	VER32-110	72	40	110	0.2	1	M10-M24	V40-ER32	4.25
	VER40-115	87	50	115	0.2	1	M14-M33	V50-ER40	4.45



ACCESSORIES

配件

C



### DSK直柄弹性筒夹延长杆

DSK Collet Extender

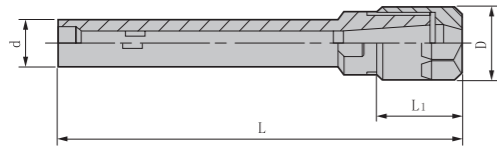

订货号 Ordering Code	尺寸 Dimension ( mm )				重量 Weight ( kg )	
	D	d	L1	L		
C20-	DSK6-120	20	20	20	120	0.28
	DSK6-150	20	20	20	150	0.40
	DSK6-180	20	20	20	180	0.55
	DSK10-120	29	20	38	120	0.36
	DSK10-150	29	20	38	150	0.45
	DSK10-180	29	20	38	180	0.60

### M型直柄ER弹性筒夹延长杆

ER Collet Extender (M-Type)

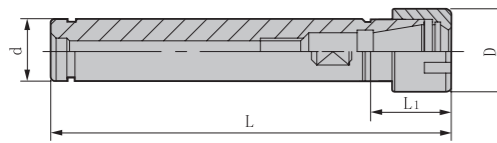

订货号 Ordering Code	尺寸 Dimension ( mm )				重量 Weight ( kg )	
	D	d	L1	L		
C12-	ER11M-100	16	12	25	125	0.12
	ER11M-150	16	12	25	175	0.14
C16-	ER11M-100	16	16	25	125	0.14
	ER11M-150	16	16	25	175	0.22
	ER16M-100	22	16	36	136	0.15
	ER16M-150	22	16	36	186	0.21
C20-	ER16M-100	22	20	36	136	0.24
	ER16M-150	22	20	36	186	0.33
	ER20M-100	28	20	42	142	0.23
	ER20M-150	28	20	42	192	0.32
	ER20M-200	28	20	42	242	0.53
C25-	ER25M-100	35	20	50	150	0.55
	ER20M-150	28	25	42	192	0.50

### ER弹性筒夹延长杆

ER Collet Extender

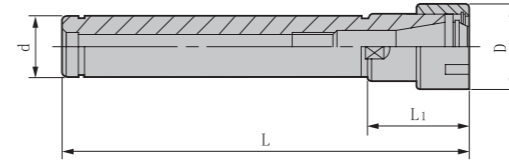

订货号 Ordering Code	尺寸 Dimension ( mm )				重量 Weight ( kg )	
	D	d	L1	L		
C16-	ER16-100	28	16	37	137	0.20
	ER16-150	28	16	37	187	0.25
	ER20-100	35	16	42	142	0.25
C20-	ER16-100	28	20	37	137	0.28
	ER16-150	28	20	37	187	0.36
	ER20-100	35	20	42	142	0.30
	ER20-150	35	20	42	192	0.38
	ER25-100	42	20	46	146	0.41
	ER25-150	42	20	46	196	0.49
C25-	ER16-100	28	25	37	137	0.41
	ER16-150	28	25	37	187	0.54
	ER20-100	35	25	42	142	0.42
	ER20-150	35	25	42	192	0.55
	ER25-100	42	25	46	146	0.45
	ER25-150	42	25	46	196	0.65

### VER快换式微补偿攻牙延长杆

VER Synchronized Tapping Extender

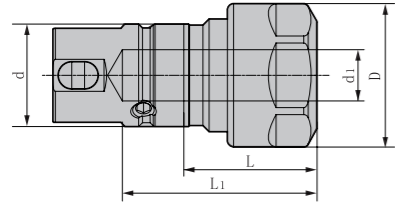

订货号 Ordering Code	夹持范围 Clamping Range (mm)	尺寸 Dimension (mm)				攻牙范围 Tapping Range (mm)	重量 Weight (kg)	
		D	d	L1	L			
V20-	ER16-24	2-10	28	20	37	24	M3-M12	0.15
	ER16-55	2-10	28	20	37	55	M3-M12	0.22
V25-	ER20-26	2-13	34	25	45	26	M5-M16	0.20
	ER20-75	2-13	34	25	45	75	M5-M16	0.29
V32-	ER25-28	2-16	42	32	52	28	M6-M20	0.35
	ER25-86	2-16	42	32	63	86	M6-M20	0.54
V40-	ER32-30	4-20	50	40	64	30	M10-M24	0.50
	ER32-90	4-20	50	40	64	90	M10-M24	0.81
V50-	ER40-32	6-26	63	50	75	32	M14-M33	0.65
	ER40-95	6-26	63	50	75	95	M14-M33	0.98

### SF热缩延长杆

SF Shrink Fit Extender

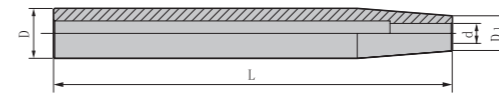

订货号 Ordering Code	尺寸 Dimension (mm)				重量 Weight (kg)	
	D	D1	d	L		
C12-	SF3-160	12	8	3	160	0.20
	SF4-160	12	8	4	160	0.21
C16-	SF3-160	16	10	3	160	0.22
	SF4-160	16	10	4	160	0.23
	SF5-160	16	10	5	160	0.24
C20-	SF6-160	16	10	6	160	0.25
	SF5-160	20	14	5	160	0.40
	SF6-160	20	14	6	160	0.42
C25-	SF8-160	20	14	8	160	0.44
	SF8-160	25	20	8	160	0.60
	SF10-160	25	20	10	160	0.62
C32-	SF12-160	25	20	12	160	0.65
	SF10-160	32	27	10	160	0.78
	SF12-160	32	27	12	160	0.81
	SF16-160	32	27	16	160	0.83
	SF20-160	32	27	20	160	0.85

### DSK精密弹性筒夹

DSK Precision Collet

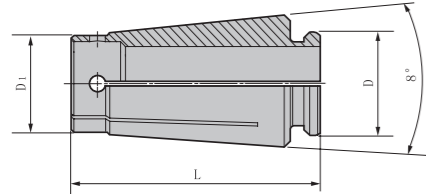

订货号 Ordering Code	尺寸 Dimension ( mm )		
	D	D1	d
DSK 6	9	7.5	25
DSK 10	13	11.9	30.5
DSK 16	20.3	18.7	45
DSK 20	24	23	50
DSK 25	29.3	28.7	57

DSK6-11PCS		
订货号 Ordering Code	范围 Range ( mm )	
DSK6- 2	1.8-2.0	
DSK6- 2.5	2.3-2.5	
DSK6- 3	2.8-3.0	
DSK6- 3.5	3.0-3.5	
DSK6- 4	3.5-4.0	
DSK6- 4.5	4.0-4.5	
DSK6- 5	4.5-5.0	
DSK6- 5.5	5.0-5.5	
DSK6- 6	5.5-6.0	

DSK10-18PCS		
订货号 Ordering Code	范围 Range ( mm )	
DSK10- 2	1.75-2.0	
DSK10- 3	2.75-3.0	
DSK10- 3.5	3.0-3.5	
DSK10- 4	3.5-4.0	
DSK10- 4.5	4.0-4.5	
DSK10- 5	4.5-5.0	
DSK10- 5.5	5.0-5.5	
DSK10- 6	5.5-6.0	
DSK10- 6.5	6.0-6.5	
DSK10- 7	6.5-7.0	
DSK10- 7.5	7.0-7.5	
DSK10- 8	7.5-8.0	
DSK10- 8.5	8.0-8.5	
DSK10- 9	8.5-9.0	
DSK10- 9.5	9.0-9.5	
DSK10- 10	9.5-10.0	

DSK16-27PCS		
订货号 Ordering Code	范围 Range ( mm )	
DSK16- 3	2.75-3.0	
DSK16- 3.5	3.0-3.5	
DSK16- 4	3.5-4.0	
DSK16- 4.5	4.0-4.5	
DSK16- 5	4.5-5.0	
DSK16- 5.5	5.0-5.5	
DSK16- 6	5.5-6.0	
DSK16- 6.5	6.0-6.5	
DSK16- 7	6.5-7.0	
DSK16- 7.5	7.0-7.5	
DSK16- 8	7.5-8.0	
DSK16- 8.5	8.0-8.5	
DSK16- 9	8.5-9.0	
DSK16- 9.5	9.0-9.5	
DSK16- 10	9.5-10.0	
DSK16- 10.5	10.0-10.5	
DSK16- 11	10.5-11.0	
DSK16- 11.5	11.0-11.5	
DSK16- 12	11.5-12.0	
DSK16- 12.5	12.0-12.5	
DSK16- 13	12.5-13.0	
DSK16- 13.5	13.0-13.5	
DSK16- 14	13.5-14.0	
DSK16- 14.5	14.0-14.5	
DSK16- 15	14.5-15.0	
DSK16- 15.5	15.0-15.5	
DSK16- 16	15.5-16.0	

### DSK精密弹性筒夹

DSK Precision Collet

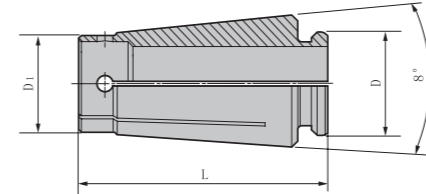

DSK20-34PCS		
订货号 Ordering Code	范围 Range ( mm )	
DSK20- 3.5	3.0-3.5	
DSK20- 4	3.5-4.0	
DSK20- 4.5	4.0-4.5	
DSK20- 5	4.5-5.0	
DSK20- 5.5	5.0-5.5	
DSK20- 6	5.5-6.0	
DSK20- 6.5	6.0-6.5	
DSK20- 7	6.5-7.0	
DSK20- 7.5	7.0-7.5	
DSK20- 8	7.5-8.0	
DSK20- 8.5	8.0-8.5	
DSK20- 9	8.5-9.0	
DSK20- 9.5	9.0-9.5	
DSK20- 10	9.5-10.0	
DSK20- 10.5	10.0-10.5	
DSK20- 11	10.5-11.0	
DSK20- 11.5	11.0-11.5	
DSK20- 12	11.5-12.0	
DSK20- 12.5	12.0-12.5	
DSK20- 13	12.5-13.0	
DSK20- 13.5	13.0-13.5	
DSK20- 14	13.5-14.0	
DSK20- 14.5	14.0-14.5	
DSK20- 15	14.5-15.0	
DSK20- 15.5	15.0-15.5	
DSK20- 16	15.5-16.0	
DSK20- 16.5	16.0-16.5	
DSK20- 17	16.5-17.0	
DSK20- 17.5	17.0-17.5	
DSK20- 18	17.5-18.0	
DSK20- 18.5	18.0-18.5	
DSK20- 19	18.5-19.0	
DSK20- 19.5	19.0-19.5	
DSK20- 20	19.5-20.0	

DSK25-45PCS		
订货号 Ordering Code	范围 Range ( mm )	
DSK25- 3.5	3.0-3.5	
DSK25- 4	3.5-4.0	
DSK25- 4.5	4.0-4.5	
DSK25- 5	4.5-5.0	
DSK25- 5.5	5.0-5.5	
DSK25- 6	5.5-6.0	
DSK25- 6.5	6.0-6.5	
DSK25- 7	6.5-7.0	
DSK25- 7.5	7.0-7.5	
DSK25- 8	7.5-8.0	
DSK25- 8.5	8.0-8.5	
DSK25- 9	8.5-9.0	
DSK25- 9.5	9.0-9.5	
DSK25- 10	9.5-10.0	
DSK25- 10.5	10.0-10.5	
DSK25- 11	10.5-11.0	
DSK25- 11.5	11.0-11.5	
DSK25- 12	11.5-12.0	
DSK25- 12.5	12.0-12.5	
DSK25- 13	12.5-13.0	
DSK25- 13.5	13.0-13.5	
DSK25- 14	13.5-14.0	
DSK25- 14.5	14.0-14.5	

DSK25-45PCS		
订货号 Ordering Code	范围 Range ( mm )	
DSK25- 15	14.5-15.0	
DSK25- 15.5	15.0-15.5	
DSK25- 16	15.5-16.0	
DSK25- 16.5	16.0-16.5	
DSK25- 17	16.5-17.0	
DSK25- 17.5	17.0-17.5	
DSK25- 18	17.5-18.0	
DSK25- 18.5	18.0-18.5	
DSK25- 19	18.5-19.0	
DSK25- 19.5	19.0-19.5	
DSK25- 20	19.5-20.0	
DSK25- 20.5	20.0-20.5	
DSK25- 21	20.5-21.0	
DSK25- 21.5	21.0-21.5	
DSK25- 22	21.5-22.0	
DSK25- 22.5	22.0-22.5	
DSK25- 23	22.5-23.0	
DSK25- 23.5	23.0-23.5	
DSK25- 24	23.5-24.0	
DSK25- 24.5	24.0-24.5	
DSK25- 25	24.5-25.0	

### ER弹性筒夹

ER Collet

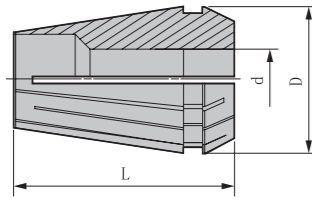

订货号 Ordering Code	尺寸 Dimension ( mm )		重量 Weight ( kg )
	D	D1	
ER	11	11.50	0.01
	16	17.00	0.03
	20	21.00	0.04
	25	26	0.06
	32	33	0.10
	40	41	0.25

特点 / Feature  
 • ER11的夹持范围为0.5mm, ER16/20/25/32/40的夹持范围为1mm。  
 Chucking range: ER11=0.5mm, ER16/20/25/32/40=1mm.

弹性筒夹精度说明 / Spring Collet Precision  
 • 普通级: 小于等于0.015mm  
 Standard: ≤ 0.015 mm  
 • A级: 小于等于0.01mm  
 A: ≤ 0.01 mm  
 • UP级: 小于等于0.005mm  
 UP: ≤ 0.005 mm

注 / Note  
 • ER11-13PCS为套装形式, 另有止水内冷型 ER 筒夹可选配。例: ER16-5C  
 ER11-13PCS are in the form of a suit, ER Collets with internal cooling are available. Example: ER16-5C.

### ER筒夹命名规则 / Naming Rule

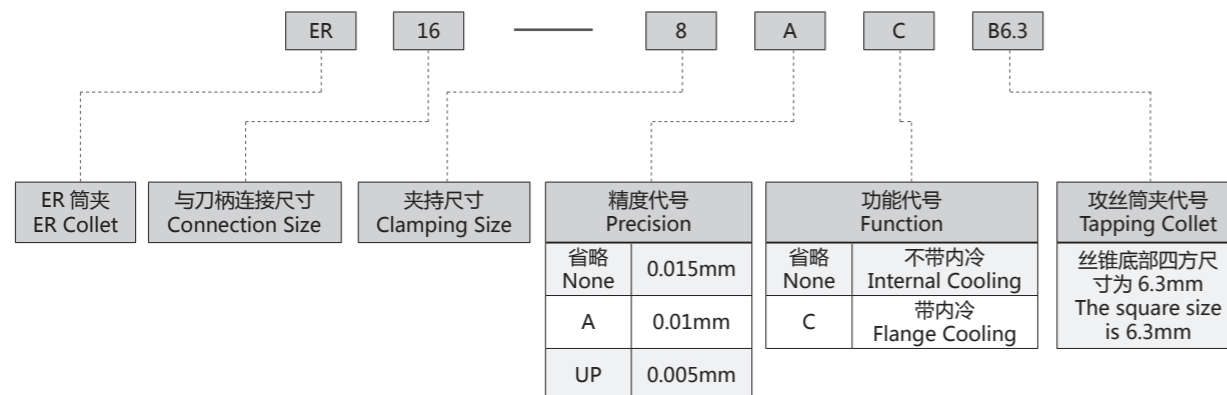

### ER弹性筒夹

ER Collet

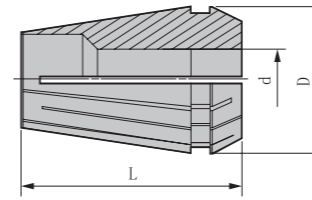

ER11-13PCS		
订货号 Ordering Code	范围 Range ( mm )	
ER11-	1	1.0-0.5
	1.5	1.5-1.0
	2	2.0-1.5
	2.5	2.5-2.0
	3	3.0-2.5
	3.5	3.5-3.0
	4	4.0-3.5
	4.5	4.5-4.0
	5	5.0-4.5
	5.5	5.5-5.0
	6	6.0-5.5
	6.5	6.5-6.0
	7	7.0-6.5

ER16-10PCS		
订货号 Ordering Code	范围 Range ( mm )	
ER16-	1	1.0-0.5
	2	2.0-1.0
	3	3.0-2.0
	4	4.0-3.0
	5	5.0-4.0
	6	6.0-5.0
	7	7.0-6.0
	8	8.0-7.0
	9	9.0-8.0
	10	10-9.0

ER20-12PCS		
订货号 Ordering Code	范围 Range ( mm )	
ER20-	2	2.0-1.0
	3	3.0-2.0
	4	4.0-3.0
	5	5.0-4.0
	6	6.0-5.0
	7	7.0-6.0
	8	8.0-7.0
	9	9.0-8.0
	10	10-9.0
	11	11-10
	12	12-11
	13	13-12

ER25-15PCS		
订货号 Ordering Code	范围 Range ( mm )	
ER25-	2	2.0-1.0
	3	3.0-2.0
	4	4.0-3.0
	5	5.0-4.0
	6	6.0-5.0
	7	7.0-6.0
	8	8.0-7.0
	9	9.0-8.0
	10	10-9.0
	11	11-10
	12	12-11
	13	13-12
	14	14-13
	15	15-14
	16	16-15

ER32-19PCS		
订货号 Ordering Code	范围 Range ( mm )	
ER32-	2	2.0-1.0
	3	3.0-2.0
	4	4.0-3.0
	5	5.0-4.0
	6	6.0-5.0
	7	7.0-6.0
	8	8.0-7.0
	9	9.0-8.0
	10	10-9.0
	11	11-10
	12	12-11
	13	13-12
	14	14-13
	15	15-14
	16	16-15
	17	17-16
	18	18-17
	19	19-18
	20	20-19

ER40-24PCS		
订货号 Ordering Code	范围 Range ( mm )	
ER40-	3	3.0-2.0
	4	4.0-3.0
	5	5.0-4.0
	6	6.0-5.0
	7	7.0-6.0
	8	8.0-7.0
	9	9.0-8.0
	10	10-9.0
	11	11-10
	12	12-11
	13	13-12
	14	14-13
	15	15-14
	16	16-15
	17	17-16
	18	18-17
	19	19-18
	20	20-19
	21	21-20
	22	22-21
	23	23-22
	24	24-23
	25	25-24
	26	26-25

### ER攻丝筒夹

ER Tapping Collet

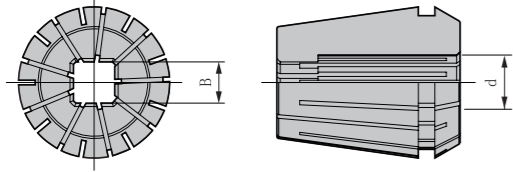

订货号 Ordering Code					尺寸 Dimension (mm)			丝锥标准 Taps					
					d	B		ISO529(1)	ISO529(2)	JIS	DIN371	DIN376	
ER16-					2.24B1.8	2.24	1.8	-	M3	-	-	-	
ER16-					2.8B2.1	2.8	2.1	-	-	-	-	-	M4
ER16-					3.15B2.5	3.15	2.5	M3	M4	-	-	-	
ER16-					3.5B2.7	3.5	2.7	-	-	-	M3	M5	
ER16-	ER20-				4B3.2	4	3.2	M4	M5	M3	-	-	
ER16-	ER20-	ER25-			4.5B3.55	4.5	3.55	-	M6	-	-	-	
ER16-	ER20-	ER25-			5B4	5	4	M5	-	M4	-	-	
ER16-	ER20-	ER25-			5.5B4.5	5.5	4.5	-	-	M5、W3/16	-	-	
ER16-	ER20-	ER25-			6B4.5	6	4.5	-	-	M6、W1/4	-	-	
ER16-	ER20-	ER25-			6.2B5	6.2	5	-	-	M8	-	-	
ER16-	ER20-	ER25-			6.3B5	6.3	5	M6	M8	-	-	-	
ER16-	ER20-	ER25-	ER32-		7B5.5	7	5.5	-	-	M10、W3/8	-	M10	
ER16-	ER20-	ER25-	ER32-		8B6.3	8	6.3	M8	M10	-	-	-	
ER16-	ER20-	ER25-	ER32-		8.5B6.5	8.5	6.5	-	-	M12	-	-	
ER16-	ER20-	ER25-	ER32-		9B7.1	9	7.1	-	M12	-	-	M12	
ER16-	ER20-	ER25-	ER32-	ER40-	10B8	10	8	M10	-	-	M10	-	
	ER20-	ER25-	ER32-	ER40-	10.5B8	10.5	8	-	-	M14	-	-	
	ER20-	ER25-	ER32-	ER40-	11.2B9	11.2	9	-	M14	-	-	-	
	ER20-	ER25-	ER32-	ER40-	12.5B10	12.5	10	-	M16	M16	-	-	
		ER25-	ER32-	ER40-	14B11.2	14	11.2	-	M18、M20-	M18	-	-	
		ER25-	ER32-	ER40-	15B12	15	12	-	-	M20-	-	-	
			ER32-	ER40-	16B12.5	16	12.5	-	M22	-	-	-	
			ER32-	ER40-	17B13	17	13	-	-	M22	-	-	
			ER32-	ER40-	18B14	18	14	-	M24	-	-	-	
			ER32-	ER40-	19B15	19	15	-	-	M24	-	-	
				ER40-	20B15	20	15	-	-	M27	-	-	
				ER40-	20B16	20	16	-	M27、M30	-	-	M27	
				ER40-	22B18	22	18	-	-	-	-	M30	
				ER40-	22B19	22	19	-	-	M32、M33	-	-	
				ER40-	22.4B18	22.4	18	-	M33	-	-	-	
				ER40-	23B17	23	17	-	-	M30	-	-	
				ER40-	25B19	25	19	-	-	M33	-	-	

注 / Note

- 安装丝锥时柄方必须伸入筒夹方槽内部。  
The handle of the tap must be inserted into the square slot.
- 选型前需确认丝锥柄径与四方尺寸。  
Please confirm the diameter of the taper shank and the size of the square before choosing the type.

### GC强力弹性直筒夹

GC Straight Collet

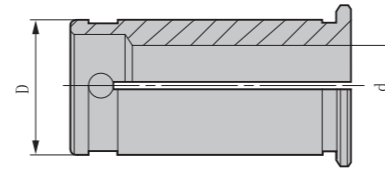

订货号 Ordering Code		尺寸 Dimension (mm)		特殊规格 (d)	
		D	d		
GC16-	3	16	3	-	
	4	16	4	-	
	5	16	5	-	
	6	16	6	-	
	7	16	7	-	
	8	16	8	-	
	9	16	9	-	
	10	16	10	-	
	11	16	11	-	
	12	16	12	-	
	GC20-	6	20	6	-
		8	20	8	-
10		20	10	-	
12		20	12	-	
16		20	16	15	
GC32-	6	32	6	-	
	8	32	8	-	
	10	32	10	-	
	12	32	12	-	
	16	32	16	15	
	20	32	20	19	
	25	32	25	24	
GC42-	6	42	6	-	
	8	42	8	-	
	10	42	10	-	
	12	42	12	-	
	16	42	16	15	
	20	42	20	19	
	25	42	25	24	
	32	42	32	31	

### D型端面出水液压筒夹

Hydraulic Collet - Flange Cooling

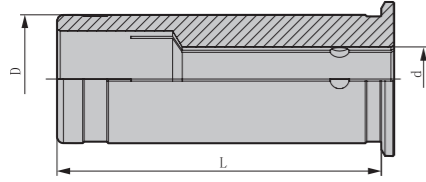

订货号 Ordering Code	尺寸 Dimension ( mm )		
	d	D	L
DHC12-	3	12	45
	4	12	45
	5	12	45
	6	12	45
	8	12	45
DHC20-	3	20	50.5
	4	20	50.5
	5	20	50.5
	6	20	50.5
	8	20	50.5
	10	20	50.5
	12	20	50.5
	14	20	50.5
DHC32-	6	32	60.5
	8	32	60.5
	10	32	60.5
	12	32	60.5
	14	32	60.5
	16	32	60.5
	18	32	60.5
	20	32	60.5
25	32	60.5	

### OD型中心出水液压筒夹

Hydraulic Collet - Internal Cooling

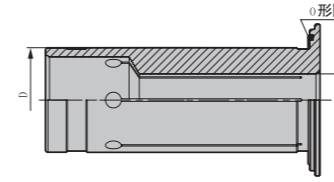

订货号 Ordering Code	尺寸 Dimension ( mm )		
	d	D	L
ODHC12-	3	12	45
	4	12	45
	5	12	45
	6	12	45
	8	12	45
ODHC20-	3	20	50.5
	4	20	50.5
	5	20	50.5
	6	20	50.5
	8	20	50.5
	10	20	50.5
	12	20	50.5
	14	20	50.5
ODHC32-	6	32	60.5
	8	32	60.5
	10	32	60.5
	12	32	60.5
	14	32	60.5
	16	32	60.5
	18	32	60.5
	20	32	60.5
25	32	60.5	

### TPD316 丝锥筒夹

TPD316 Tapping Collet

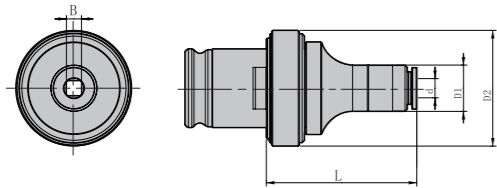

订货号 Ordering Code	尺寸 Dimension ( mm )				丝锥标准 Taps					
	d	B	D1	D2	ISO529(1)	ISO529(2)	JIS	DIN371	DIN376	
2.8B2.1-L	2.8	2.1	20	33	-	-	-	-	M4	
3.15B2.5-L	3.15	2.5	20	33	M4	M3	-	-	-	
3.5B2.7-L	3.5	2.7	20	33	-	-	-	M3	M5	
4B3.15-L	4	3.15	20	33	M5	M4	-	-	-	
4B3.2-L	4	3.2	20	33	-	-	M3; W1/8	-	-	
4.5B3.4-L	4.5	3.4	20	33	-	-	-	M4	M6	
4.5B3.55-L	4.5	3.55	20	33	M6	-	-	-	-	
5B4-L	5	4	20	33	-	M5	M4	-	-	
5.5B4.5-L	5.5	4.5	20	33	-	-	M5; W3/16	-	-	
6B4.5-L	6	4.5	20	33	-	-	M6; W1/4	-	-	
6B4.9-L	6	4.9	20	33	-	-	-	M5 M6	M8	
6.1B5-L	6.1	5	20	33	-	-	W5/16	-	-	
6.2B5-L	6.2	5	20	33	-	-	M8	-	-	
6.3B5-L	6.3	5	20	33	M8	M6	-	-	-	
7B5.5-L	7	5.5	20	33	-	-	M10; W3/8	-	M10	
8B6-L	8	6	20	33	-	-	W7/16; PT1/8	-	-	
8B6.2-L	8	6.2	20	33	-	-	-	M8	-	
8B6.3-L	8	6.3	20	33	M10	M8	-	-	-	
8.5B6.5-L	8.5	6.5	20	33	-	-	M12	-	-	
9B7-L	9	7	27	33	-	-	W1/2	-	M12	
9B7.1-L	9	7.1	27	33	M12	-	-	-	-	
10B8-L	10	8	27	33	-	M10	-	M10	-	
10.5B8-L	10.5	8	27	33	-	-	M14	-	-	
11B9-L	11	9	27	33	-	-	PT1/4	-	M14	
11.2B9-L	11.2	9	27	33	M14	-	-	-	-	
12B9-L	12	9	27	33	-	-	W5/8	-	M16	
12.5B10-L	12.5	10	27	33	M16	-	M16	-	-	

TPD 丝锥筒夹长度 Length ( mm )		
L	L+60	L+100
45	105	145

注 / Note  
 • ISO529 ( 1 ) 为细柄普通粗牙螺纹丝锥 ;  
 ISO529(1) : The thin tap for coarse thread.  
 • ISO529 ( 2 ) 为粗柄普通粗牙螺纹丝锥。  
 ISO529(2) : The coarse tap for coarse thread.  
 • TPD316/830 丝锥筒夹分别有三款长度可选。例 : TPD316/830-5B4-105  
 Please note the length of the tapping collet when you order. For example: TPD316/830-5B4-105

### TPD830 丝锥筒夹

TPD830 Tapping Collet

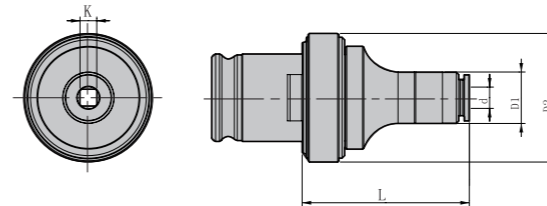

订货号 Ordering Code	尺寸 Dimension ( mm )				丝锥标准 Taps			
	d	B	D1	D2	ISO529(1)	JIS	DIN371	DIN376
6B4.9-L	6	4.9	20	50	-	-	-	M8
6.1B5-L	6.1	5	20	50	-	W5/16	-	-
6.2B5-L	6.2	5	20	50	-	M8	-	-
6.3B5-L	6.3	5	20	50	M8	-	-	-
7B5.5-L	7	5.5	20	50	-	M10; W3/8	-	M10
8B6-L	8	6	20	50	-	W7/16; PT1/8	M8	-
8B6.2-L	8	6.2	20	50	-	-	-	-
8B6.3-L	8	6.3	20	50	M10	-	-	-
8.5B6.5-L	8.5	6.5	20	50	-	M12	-	-
9B7-L	9	7	27	50	-	W1/2	-	M12
9B7.1-L	9	7.1	27	50	M12	-	-	-
10B8-L	10	8	27	50	-	-	M10	-
10.5B8-L	10.5	8	27	50	-	M14	-	-
11B9-L	11	9	27	50	-	PT1/4	-	M14
11.2B9-L	11.2	9	27	50	M14	-	-	-
12B9-L	12	9	27	50	-	W5/8	-	M16
12.5B10-L	12.5	10	27	50	M16	M16	-	-
14B11-L	14	11	32	50	-	M18; W3/4; PT3/8	-	M18
14B11.2-L	14	11.2	32	50	M18; M20	-	-	-
15B12-L	15	12	32	50	-	M20	-	-
16B12-L	16	12	32	50	-	-	-	M20
16B12.5-L	16	12.5	32	50	M22	-	-	-
17B13-L	17	13	32	50	-	M22; W7/8	-	-
18B14-L	18	14	36	50	M24	PT1/2	-	-
18B14.5-L	18	14.5	36	50	-	-	-	M22; M24
19B15-L	19	15	36	50	-	M24	-	-
20B15-L	20	15	36	50	-	M27; W1 PT5/8	-	-
20B16-L	20	16	36	50	M27; M30	-	-	M27
22B18-L	22	18	36	50	-	-	-	M30
23B17-L	23	17	36	50	-	M30; PT3/4	-	-

TPD 丝锥筒夹长度 Length ( mm )		
L	L+60	L+100
65	125	165

### 高速刀柄J型螺帽

J-Nut For High Speed Tool Holder



J型螺帽订货号 J-Nut		中心出水密封盖订货号 Nut Seal ( Internal Cooling )	扳手 Wrench
DSK	GSK		
DSK6-J	GSK6-J	MSK6-C3、3.3、4、4.2、5、6	TMSK10
DSK10-J	GSK10-J	MSK10-C3、4、4.5、5、5.5、6、6.2、6.5、6.8、7、8、8.5、10	TMSK16
DSK16-J	GSK16-J	MSK16-C7、8、8.5、10、10.3、11、11.5、12、12.5、13.5、14、15、16	TMSK20
DSK20-J	GSK20-J	MSK20-C8、10、12、16、17.5、20	TMSK25
DSK25-J	GSK25-J	MSK25-C8、10、12、16、17、17.5、18、20、25	TMSK6

J型螺帽订货号 J-Nut		端面出水密封盖订货号 Nut Seal ( Flange Cooling )	扳手 Wrench
DSK	GSK		
DSK6-J	GSK6-J	MSK6-D3、3.3、4、4.2、5、6	TMSK10
DSK10-J	GSK10-J	MSK10-D3、4、4.5、5、5.5、6、6.2、6.5、6.8、7、8、8.5、10	TMSK16
DSK16-J	GSK16-J	MSK16-D7、8、8.5、10、10.3、11、11.5、12、12.5、13.5、14、15、16	TMSK20
DSK20-J	GSK20-J	MSK20-D8、10、12、16、17.5、20	TMSK25
DSK25-J	GSK25-J	MSK25-D8、10、12、16、17、17.5、18、20、25	TMSK6

### GSK高速刀柄专用螺帽

Clamping Nuts For GSK Collet Chuck

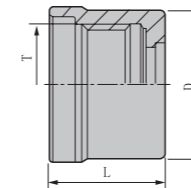

订货号 Ordering Code	尺寸 Dimension ( mm )			
	D	L	T	
GSK	6	19.5	21	M15.5x1.0P
	10	27	24	M21.5x1.0P
	16	40	31	M32x1.5P
	20	48	33	M40x1.0P
	25	55	37	M45x1.5P



### DSK高速刀柄专用螺帽 Clamping Nuts For DSK Collet Chuck

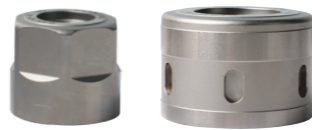
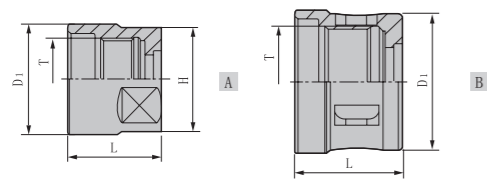

订货号 Ordering Code	图示 Figure	尺寸 Dimension ( mm )			T	
		D1	H	L		
DSK	6-A	A	20	18	21	M15.5x1.0P
	10-A	A	27.5	25	24	M21.5x1.0P
	16-M	B	40.5	-	31	M32x1.5P
	20-M	B	48	-	33	M40x1.0P
	25-M	B	55	-	37	M45x1.5P

### ER夹头螺帽 Clamping Nut For ER Collet Chuck

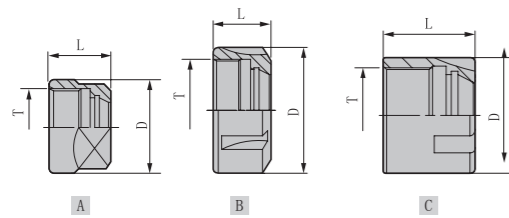

订货号 Ordering Code	图示 Figure	尺寸 Dimension ( mm )			
		D	L	T	
ER	16-A	A	28	17.5	M 22XP1.5
	20-A	A	34	19	M 25XP1.5
	25-UM/RD	B	42	20	M 32XP1.5
	32-UM/RD	B	50	22.5	M 40XP1.5
	40-UM/RD	B	63	25.5	M 50XP1.5
	11-M	C	16	12	M 13XP0.75
	16-M	C	23	18	M 19XP1.0
	20-M	C	28	19	M 24XP1.0
	25-M	C	35	20	M 30XP1.0

### GSK套筒专用扳手 Wrench For GSK Tool Holder

订货号 Ordering Code	适用螺帽 Clamping Nut	重量 Weight ( kg )	
TGSK	6	DSK6	0.30
	10	DSK10	0.35
	16	DSK16	0.40
	20	DSK20	0.50
	25	DSK25	0.55



### DSK专用扳手 Wrench For DSK Tool Holder

订货号 Ordering Code	适用螺帽 Clamping Nut	重量 Weight ( kg )	
TDSK	6-A	DSK6	0.10
	10-A	DSK10	0.10
	16-M	DSK16	0.20
	20-M	DSK20	0.30
	25-M	DSK25	0.40



### ER专用扳手 Wrench For ER Tool Holder

订货号 Ordering Code	适用螺帽 Clamping Nut	重量 Weight ( kg )	
TER	16-A	ER16-A	0.10
	20-A	ER20-A	0.10
	11-M	ER11-M	0.20
	16-M	ER16-M	0.20
	20-M	ER20-M	0.20
	25-M	ER25-M	0.20
	25-UM.KM/RD	ER25-UM/RD	0.20
	32-UM.KM/RD	ER32-UM/RD	0.20
	40-UM.KM/RD	ER40UM/RD	0.30



### GLC/HPC强力筒夹本体专用扳手 Wrench For Tool Holder GLC/HPC

订货号 Ordering Code	适用刀柄 Tool Holder	重量 Weight ( kg )	
TGLC	20	GLC20/HPC20	0.20
	32	GLC32/HPC32	0.30
	42	GLC42/HPC42	0.45



### GPU钻夹头专用扳手

Wrench For Drill Chuck GPU

订货号 Ordering Code		适用刀柄 Tool Holder	重量 Weight ( kg )
TGPU	8	GPU8	0.10
	13	GPU13	0.12
	16	GPU16	0.12



### TPD丝锥筒夹扳手

Wrench For TPD Tapping Collet

订货号 Ordering Code		适用刀柄 Tool Holder	重量 Weight ( kg )
TTPD	316	TPD316	0.10
	830	TPD830	0.12



### MSK密封盖专用扳手

Wrench For MSK Nuts Seal

订货号 Ordering Code		适用密封盖 Nut Seal	重量 Weight ( kg )
TMSK	6	MSK6	0.10
	10	MSK10	0.10
	16	MSK16	0.20
	20	MSK20	0.20



### L形扳手

Allen Key

订货号 Ordering Code	尺寸 Dimension ( mm )		
	d	L	h
TH03L	3	65	20
TH04L	4	70	25
TH05L	5	78	28
TH06L	6	85	32
TH08L	8	100	36
TH10L	10	105	40
TH12L	12	113	44
TH14L	14	118	48
TH17L	17	125	55

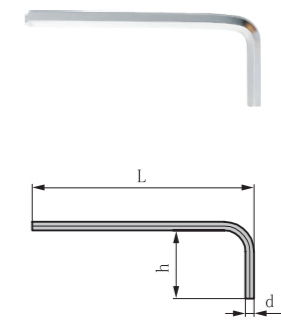

### T形扳手

Wrench - T

订货号 Ordering Code	尺寸 Dimension ( mm )		
	d	L	T
TH03T-L	3	110	3
TH04T-L	4	120	4
TH05T-L	5	150	5
TH06T-L	6	170	6
TH08T-L	8	190	8

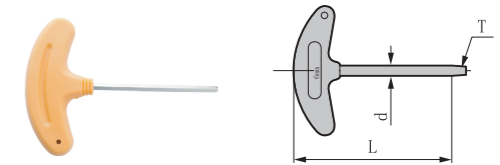

### BT拉钉

BT Pull Stud Without Hole

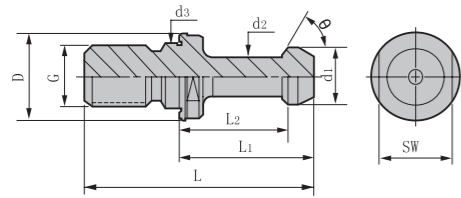

订货号 Ordering Code	尺寸 Dimension ( mm )										重量 Weight ( kg )	
	D	d1	d2	d3	L1	L2	L	θ	G	SW		
BT30-	45	16.5	11	7	12.5	23	18	43	45°	M12	13	0.03
	60	16.5	11	7	12.5	23	18	43	60°	M12	13	0.03
BT40-	45	23	15	10	17	35	28	60	45°	M16	19	0.07
	60	23	15	10	17	35	28	60	60°	M16	19	0.07
BT50-	45	38	23	17	25	45	35	85	45°	M24	30	0.25
	60	38	23	17	25	45	35	85	60°	M24	30	0.25
	90	38	23	17	25	45	35	85	90°	M24	30	0.25

### BT出水拉钉

BT Pull Stud With Cooling Hole

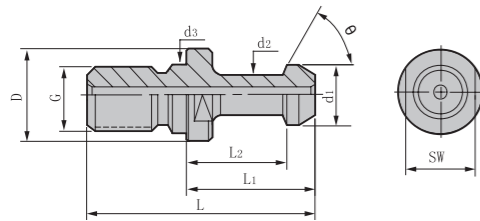

订货号 Ordering Code	出水孔径 Coolant Dia.	尺寸 Dimension ( mm )										重量 Weight ( kg )	
		D	d1	d2	d3	L1	L2	L	θ	G	SW		
BT40-	45C	4	23	15	10	17	35	28	60	45°	M16	19	0.07
	60C	4	23	15	10	17	35	28	60	60°	M16	19	0.07
	90C	4	23	15	10	17	35	28	60	90°	M16	19	0.07
BT50-	45C	6	38	23	17	25	45	35	85	45°	M24	30	0.25
	60C	6	38	23	17	25	45	35	85	60°	M24	30	0.25
	90C	6	38	23	17	25	45	35	85	90°	M24	30	0.25

### MAZAK拉钉

MAZAK Pull Stud

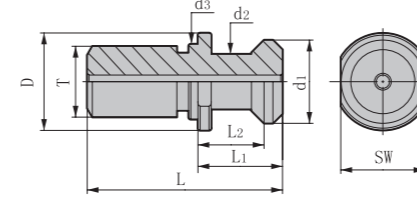

订货号 Ordering Code	尺寸 Dimension ( mm )										重量 Weight ( kg )
	D	d1	d2	d3	L	L1	L2	SW	T		
MAZAK-	40	22	18.8	12.45	17	44.1	19.1	14	19	M16	0.02
	50	37	28.96	20.83	25	65.2	25.2	25.55	30	M24	0.10

### DIN2080拉钉

DIN2080 Pull Stud

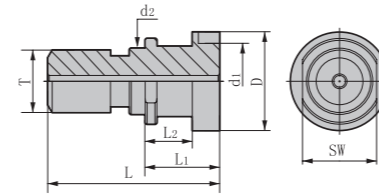

订货号 Ordering Code	尺寸 Dimension ( mm )										重量 Weight ( kg )
	D	d1	d2	d3	L	L1	L2	SW	T		
DIN2080-	40	25	21.1	17	53	25	13.6	19	M16	0.06	0.02
	50	39.3	32	25	65	25	13.35	30	M24	0.30	0.10

### MTB拉紧拉钉

MTB Tension Screw

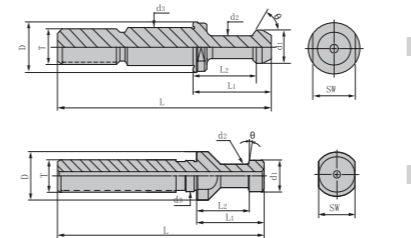

订货号 Ordering Code	图示 Figure	尺寸 Dimension ( mm )										重量 Weight ( kg )	
		D	d1	d2	d3	L1	L2	L	θ	G	SW		
BT30-	45-MT2	A	16.5	11	7	12	23	18	105	45°	M10	13	0.07
BT40-	45-MT3	A	23	15	10	17	35	28	110	45°	M12	19	0.10
	45-MT4	A	23	15	10	17	35	28	110	45°	M16	19	0.10
BT50-	45-MT5	A	38	23	17	25	45	35	165	45°	M20	30	0.65

## 专用内六角螺钉

Locking Screw

订货号 Ordering Code	尺寸 Dimension ( mm )			扳手 Wrench
	d	L	D	
SCAM040100	4	10	7	TH03L
SCAM050160	5	16	8.5	TH04L
SCAM060160	6	16	10	TH05L
SCAM060250	6	25	10	TH05L
SCAM080250	8	25	12.5	TH06L
SCAM100300	10	30	15	TH08L
SCAM100350	10	35	15	TH08L
SCAM120300	12	30	18	TH10L
SCAM120400	16	40	18	TH10L
SCAM160350	16	35	24	TH12L
SCAM160500	16	50	24	TH12L
SCAM160350-40	16	35	40	TH17L
SCAM200350-50	20	35	50	TH17L
SCAM240350-65	24	35	65	TH17L

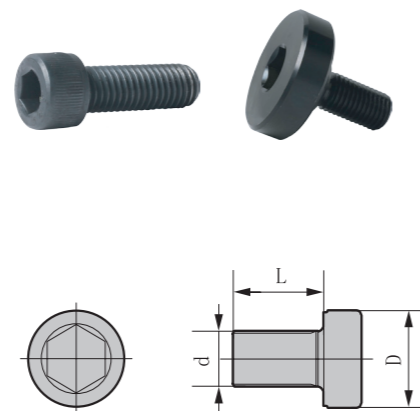

## 紧定螺钉

Locking Screw

订货号 Ordering Code	尺寸 Dimension ( mm )		扳手 Wrench
	d	L	
STBM060080	6	8	TH03L
STBM060100	6	10	TH03L
STBM080080	8	8	TH04L
STBM080100	8	10	TH04L
STBM100120	10	12	TH05L
STBM120140	12	14	TH06L
STBM140160	14	16	TH06L
STBM160160	16	16	TH08L
STCM180200	18	20	TH10L
STCM200180	20	18	TH10L
STCM200250	20	25	TH10L

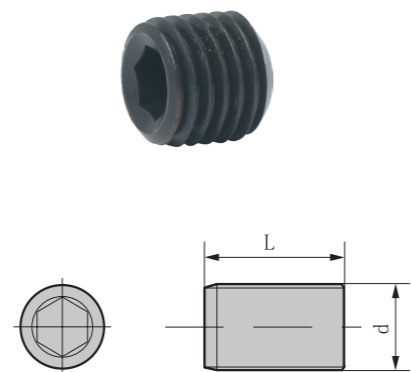

APPENDIX  
附录

D

## 热缩刀柄使用注意事项

Announcements

### 快速加热原理 / Heating



### 使用工具 / Tools

- 请使用硬质合金刀具。高速钢刀具不能热卸。  
Please use the carbide cutter. No HSS cutter.
- 使用公差范围外的刀具是刀柄破损和发生滑落事故的原因。  
No shrink release is possible for any tool for high speed steel.
- 刀具柄部的细小铁屑等附着物会和阻碍夹持孔正常装夹，造成刀具无法拔出。  
A tools exceeding its tolerance can cause breakage or slippage.

### 拉钉 ( BT ) / Retention Knob(BT)

- 请利用出水拉钉，否则请将拉钉取下后再进行加热。  
Use a retention knob that has perforations, or remove the retention knob and heat it.
- 通常拉钉不排出空气就不能放入刀具。  
The typical retention knob has no vent to release air, preventing tools from being inserted

### 冷却液导管 ( HSK ) / Coolant Duct(HSK)

- 带着冷却液导管加热时，会破坏导管的 O 型环。  
Heating the holder with coolant duct attached, the o-ring will be damaged.
- 加热时，请卸下冷却液导管。  
Remove the coolant duct before heating the holder.

### 水冷时的注意 / Precautions For Water-Cooling

- 热装之后水冷，产生大量水蒸气，有烫伤的危险性。  
Water-cooling immediately after shrink fitting may result in burns due to the large quantity of steam generated.
- 请在热装装置冷却 1 分钟以上之后进行水冷。  
Be sure to set the shrink-fitting heater setting to cool and cool the holder for at least one minute before water-cooling it.
- 请完全除去水分。残留水分后，生锈会引起刀柄破损。  
Moisture left on the holder may lead to rust formation and damage to the holder, so be sure to completely remove all moisture.

## HSK柄尺寸图

HSK Tool Holder Dimension - DIN69893

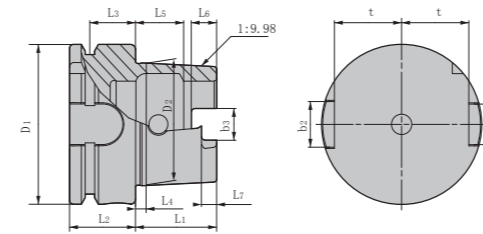

订货号 Ordering Code	尺寸 Dimension ( mm )												
	D1	D2	L1	L2	L3	L4	L5	L6	L7	b1	b2	b3	t
HSK40A	40	30.007	20	20	16	4	11.42	6	3.5	11	9	8.05	17
HSK50A	50	38.009	25	26	18	5	14.13	7.5	4.5	14	12	10.54	21
HSK63A	63	48.01	32	26	18	6.3	18.13	10	6	18	16	12.5	26.5
HSK100A	100	75.013	50	29	20	10	28.56	15	10	22	20	20	44

## BT柄尺寸图

BT Tool Holder Dimension - JIS MAS403

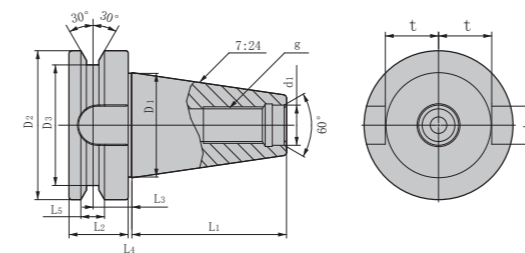

订货号 Ordering Code	尺寸 Dimension ( mm )											
	D1	d1	L1	D2	D3	L2	L3	L4	L5	b	t	g
BT30	31.75	12.5	48.4	46	38	20	13.6	2	8	16.1	16.3	M12
BT40	44.45	17	65.4	63	53	25	16.6	2	10	16.1	22.6	M16
BT50	69.85	25	101.8	100	85	35	23.2	3	15	25.7	35.4	M24



[www.gesac.ru](http://www.gesac.ru)

---

ООО "Точные Машины"

Официальный дистрибьютор GESAC в России и Казахстане  
620078, г. Екатеринбург, ул. Педагогическая, 8а, офис 23

Тел./факс: +7 343 288 53 28

e-mail: [zakaz@gesac.ru](mailto:zakaz@gesac.ru)

---